



Installation instructions, accessories

Volvo Car Corporation Gothenburg, Sweden

Instruction No 31664637
Version 1.1
Part. No. 31664635

Bumper cover

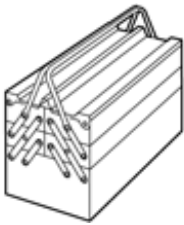
Materials	
Designation	Part number
Isopropanol	
Masking tape	

Equipment	
 IMG-345497	 IMG-397698

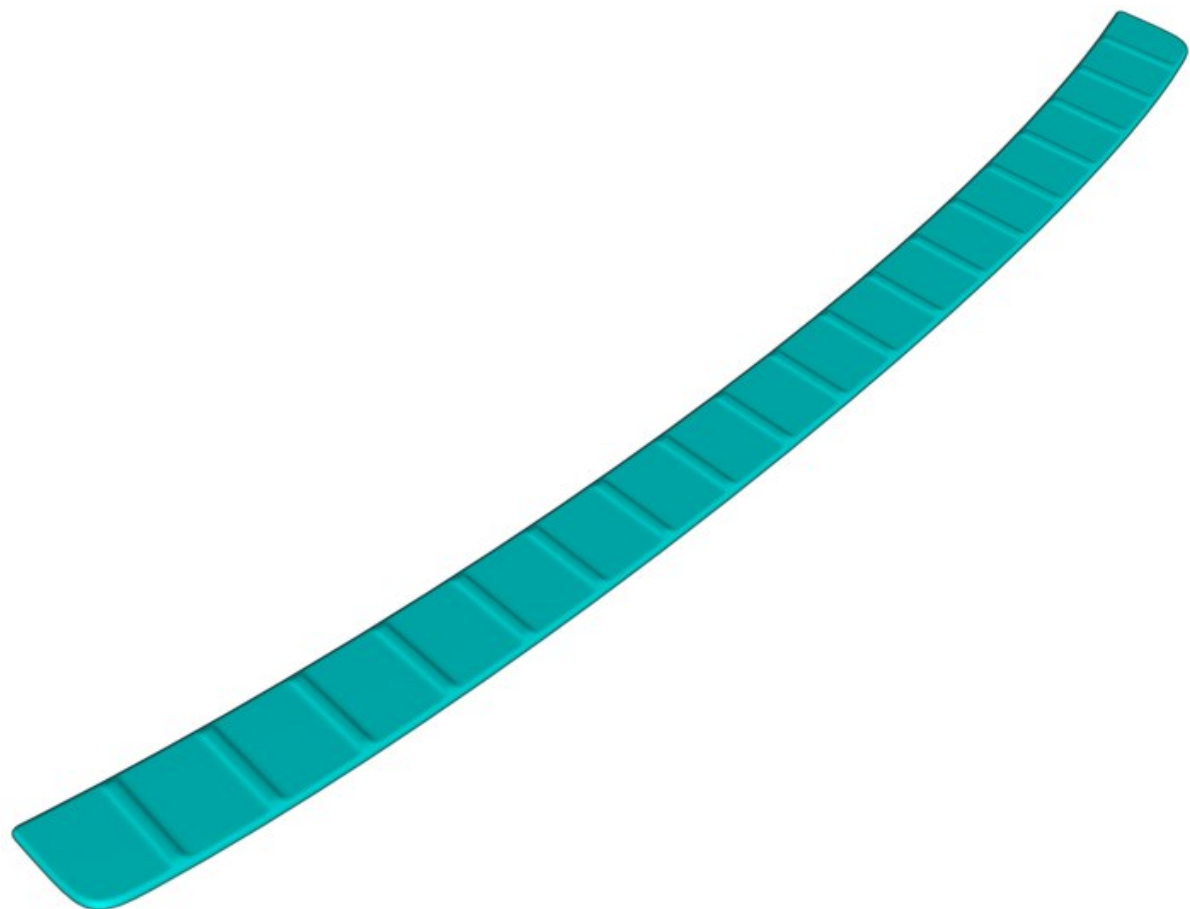

IMG-450887

Installation instructions, accessories

Volvo Car Corporation Gothenburg, Sweden

Installation instructions, accessories

Volvo Car Corporation Gothenburg, Sweden

Information

- | | |
|---|---|
| 1 | <p>Read through all of the instructions before starting installation.</p> <p>Notifications and warning texts are for your safety and to minimise the risk of something breaking during installation.</p> <p>Ensure that all tools stated in the instructions are available before starting installation.</p> <p>Certain steps in the instructions are only presented in the form of images. Explanatory text is also given for more complicated steps.</p> <p>In the event of any problems with the instructions or the accessory, contact your local Volvo dealer.</p> |
|---|---|
-

Conditions

- | | |
|---|---|
| 2 | <p>When installing, the car must retain a temperature of 20 degrees C.</p> <p>After installation, the car must not be washed for 48 hours</p> |
|---|---|



IMG-400007

Color symbols

Installation instructions, accessories

Volvo Car Corporation Gothenburg, Sweden

3

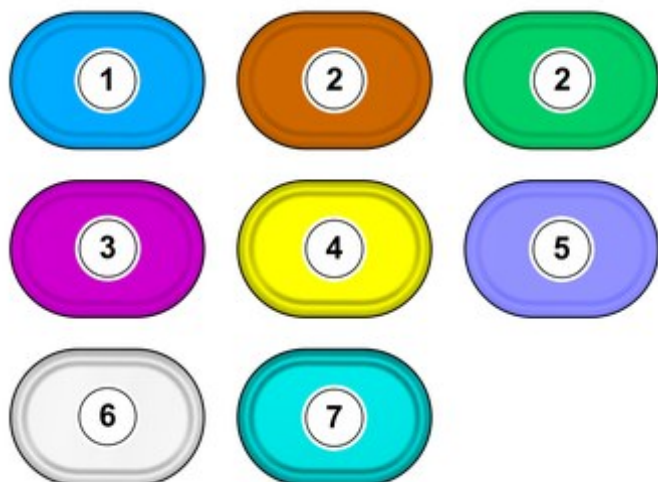

IMG-400010

Note!

This colour chart displays (in colour print and electronic version) the importance of the different colours used in the images of the method steps.

1. Used for focused component, the component with which you will do something.
2. Used as extra colors when you need to show or differentiate additional parts.
3. Used for attachments that are to be removed/installed. May be screws, clips, connectors, etc.
4. Used when the component is not fully removed from the vehicle but only hung to the side.
5. Used for standard tools and special tools.
6. Used as background color for vehicle components.
7. Used for accessory components.

Preparation

4

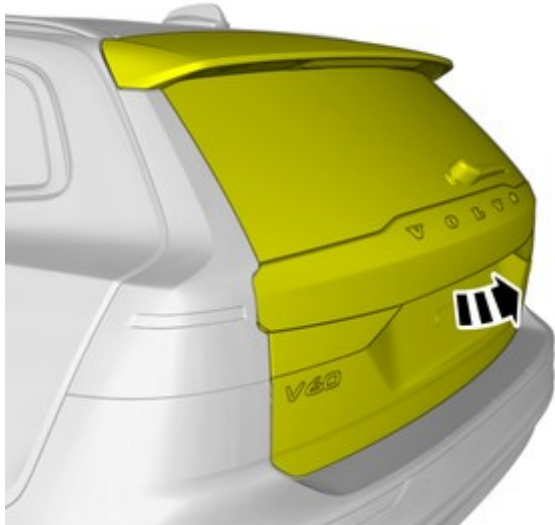

IMG-450821

Open the tailgate.

Installation instructions, accessories

Volvo Car Corporation Gothenburg, Sweden

5

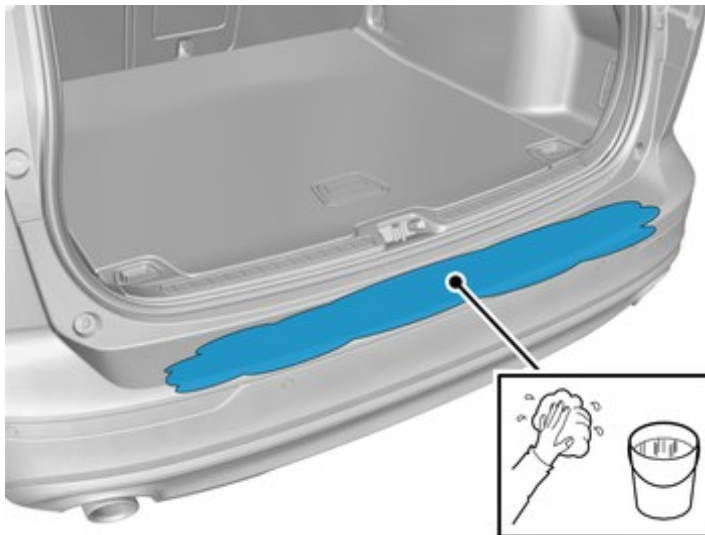

IMG-450822

Clean the surface.

6

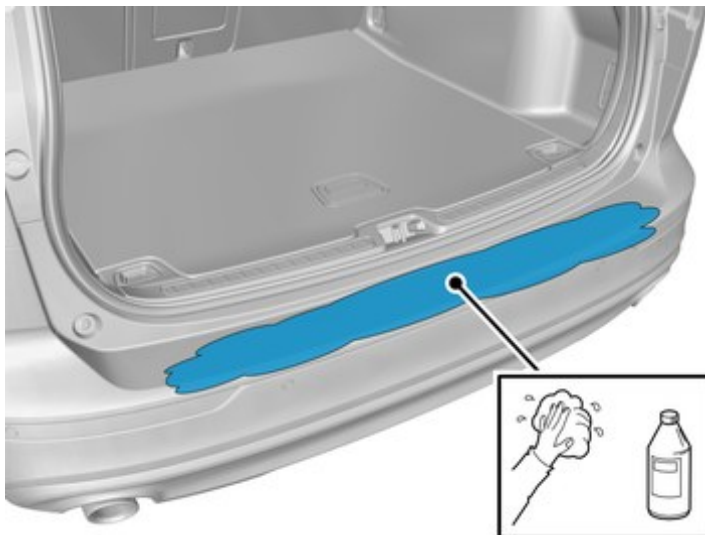

IMG-450823

Wipe off

Use: , Isopropanol

Allow to dry.

Installation instructions, accessories

Volvo Car Corporation Gothenburg, Sweden

7

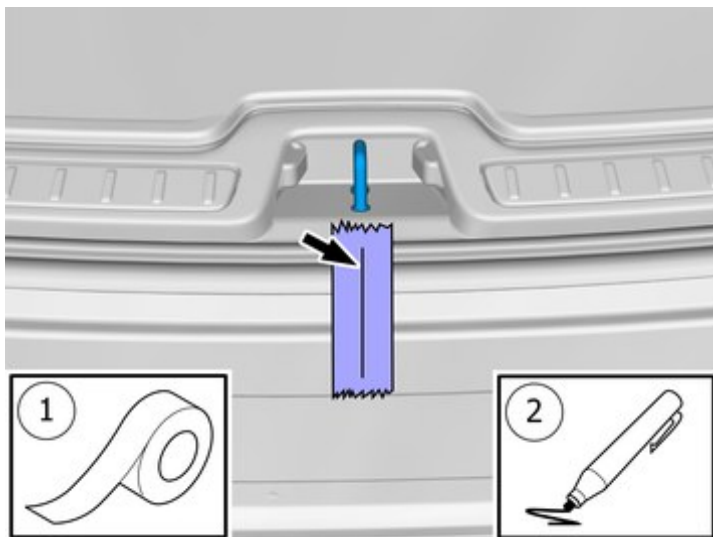

IMG-450835

Accessory installation

8

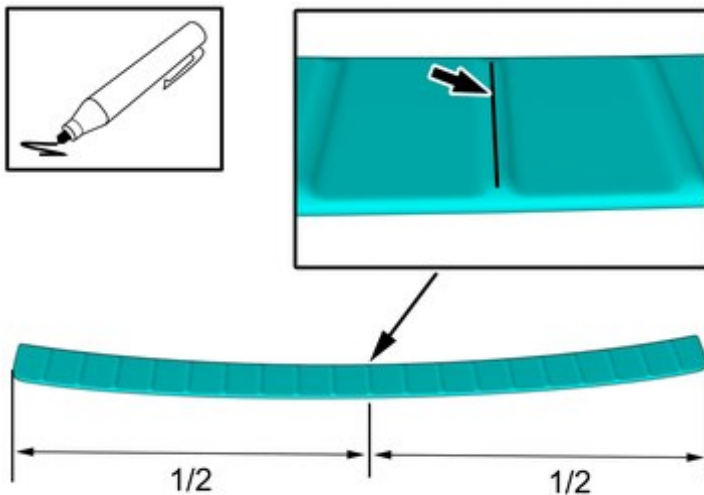

IMG-450875

Installation instructions, accessories

Volvo Car Corporation Gothenburg, Sweden

9

Fold the protective film forward

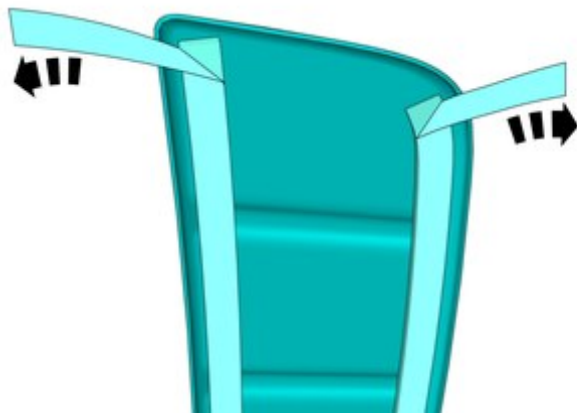

IMG-450910

10

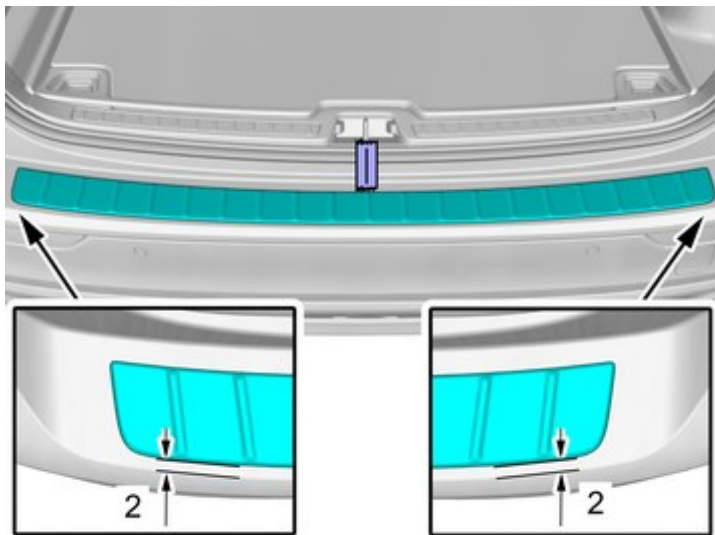

IMG-450880

Place the component where indicated in the graphic.

Measure

Use: Vernier caliper

Installation instructions, accessories

Volvo Car Corporation Gothenburg, Sweden

11

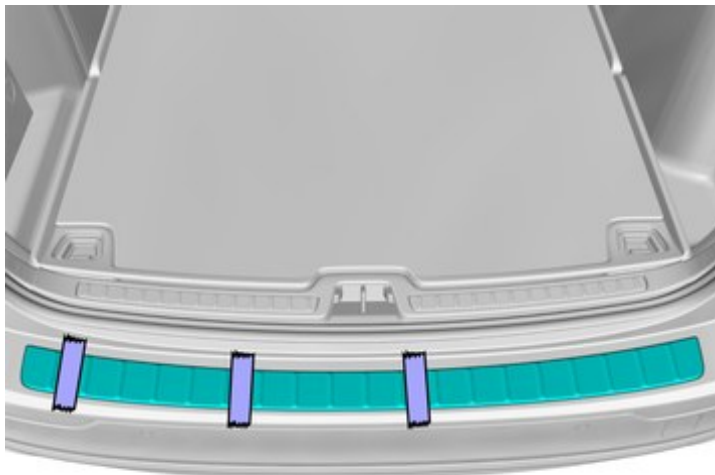

Allow the Bumper Protection to adhere to the Bumper Cover as indicated.

Use: , Masking tape

IMG-450882

12

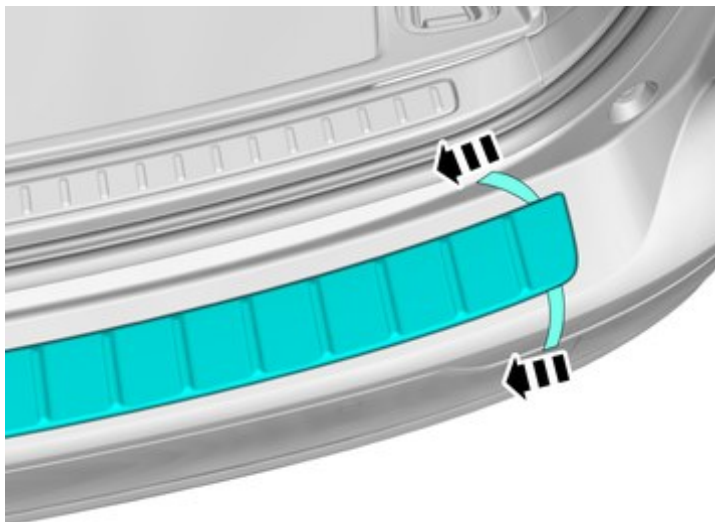

Remove the protective film.

IMG-450884

Installation instructions, accessories

Volvo Car Corporation Gothenburg, Sweden

13

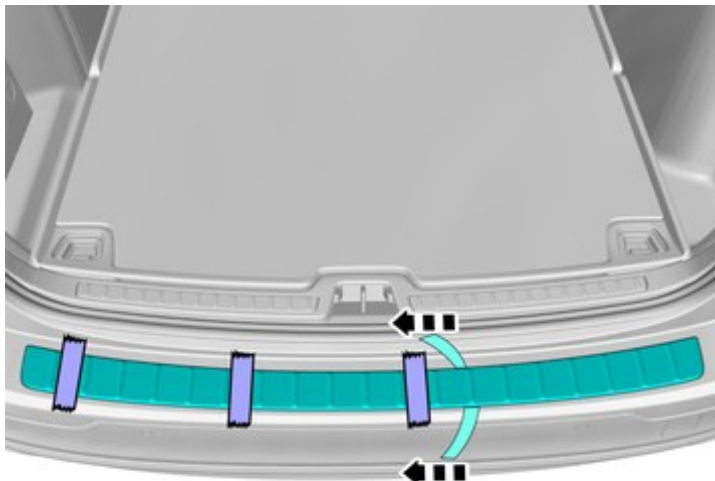

IMG-450982

Remove the tape.

Pull off the rest of the transparent foil and press by hand on the Bumper protection to make it cling to the Bumper Cover.

14

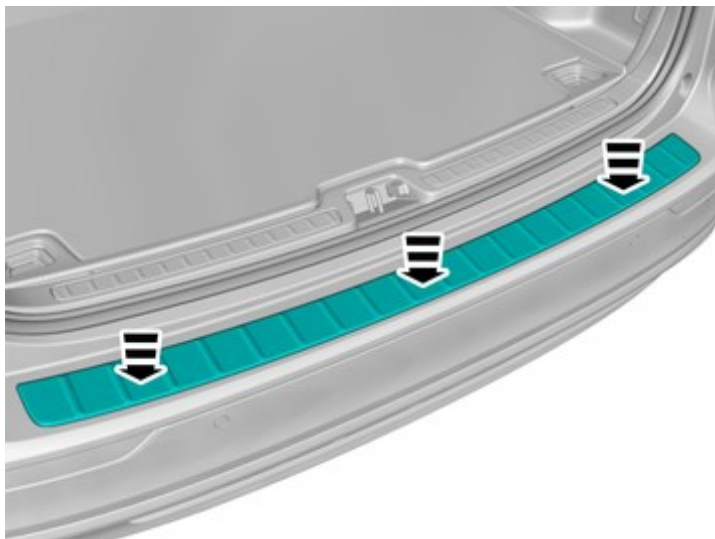

IMG-450885

Thoroughly press, by hand, all over the Bumper Protection to make it cling properly.

Installation instructions, accessories

Volvo Car Corporation Gothenburg, Sweden

15

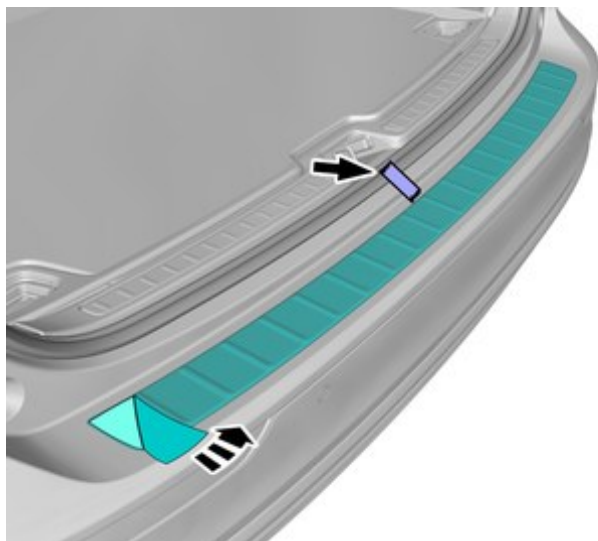

IMG-450934

Remove the tape.

Remove the protective film.