

Installation instructions, accessories

Volvo Car Corporation Gothenburg, Sweden

Instruction No	Version	Part. No.
31213819	1.2	31378095, 31213816

Sill decor

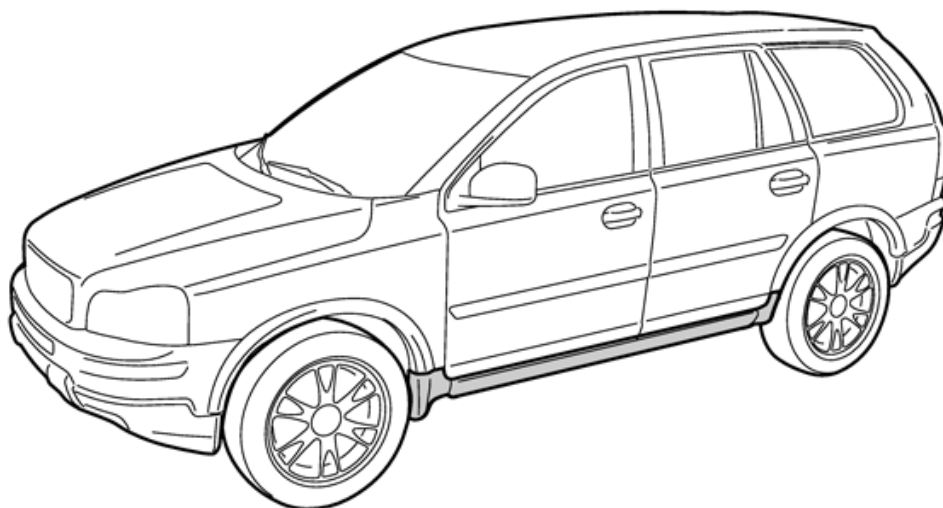

IMG-265384

Equipment



A0000162



IMG-239660



IMG-239664

Nm
lbf.ft

Installation instructions, accessories

Volvo Car Corporation Gothenburg, Sweden

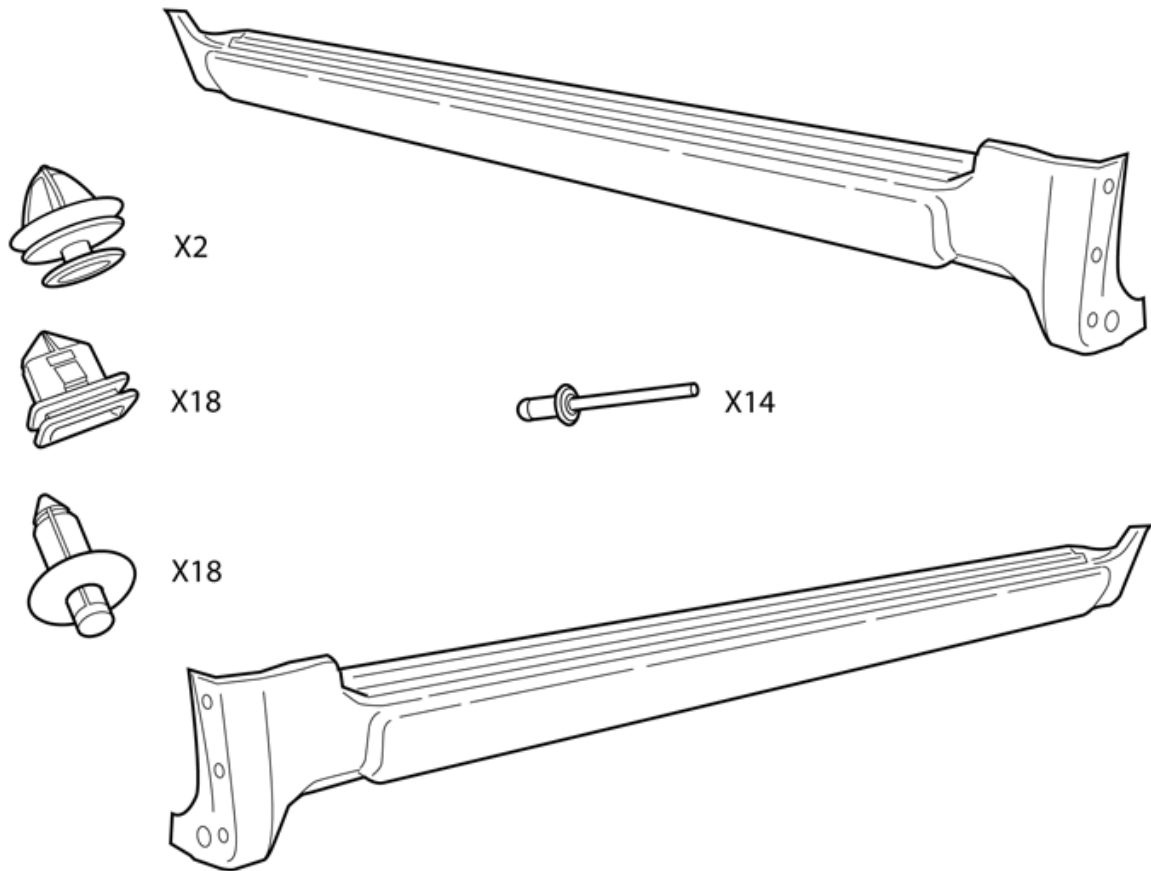

IMG-265383

Installation instructions, accessories

Volvo Car Corporation Gothenburg, Sweden

INTRODUCTION

Read through all of the instructions before starting installation.

Notifications and warning texts are for your safety and to minimise the risk of something breaking during installation.

Ensure that all tools stated in the instructions are available before starting installation.

Certain steps in the instructions are only presented in the form of images. Explanatory text is also given for more complicated steps.

In the event of any problems with the instructions or the accessory, contact your local Volvo dealer.

Preparations

1



IMG-265385

Preparations

Remove the front and rear wheels on one side.

Installation instructions, accessories

Volvo Car Corporation Gothenburg, Sweden

2

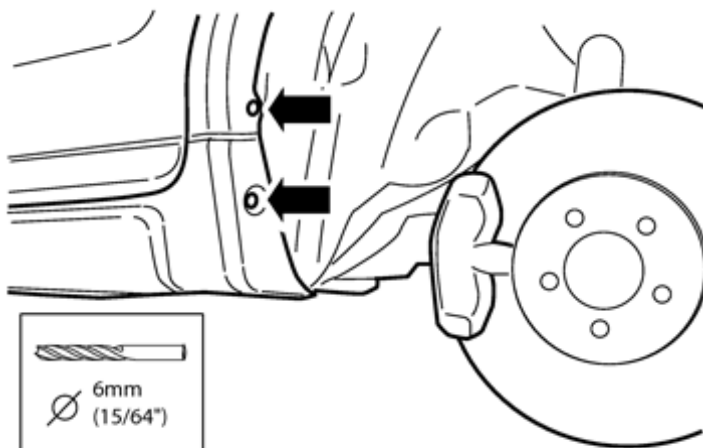

Drill out the pop rivet at the rear edge of the door sill panel and the rear pop rivet in the wing extender. Use a Ø6 mm (15/64") drill bit.

Remove any swarf and rivet residue.

IMG-265386

3

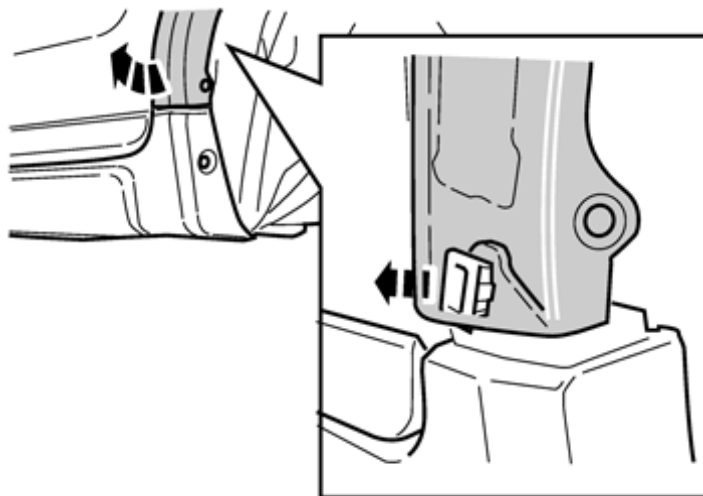

Carefully turn out the lower edge/rear edge of the front end of the wing extender.

Note!

Do not turn excessively so that the tape at the front edge detaches.

Remove the clip holding the rear end of the door sill panel.

IMG-265387

Installation instructions, accessories

Volvo Car Corporation Gothenburg, Sweden

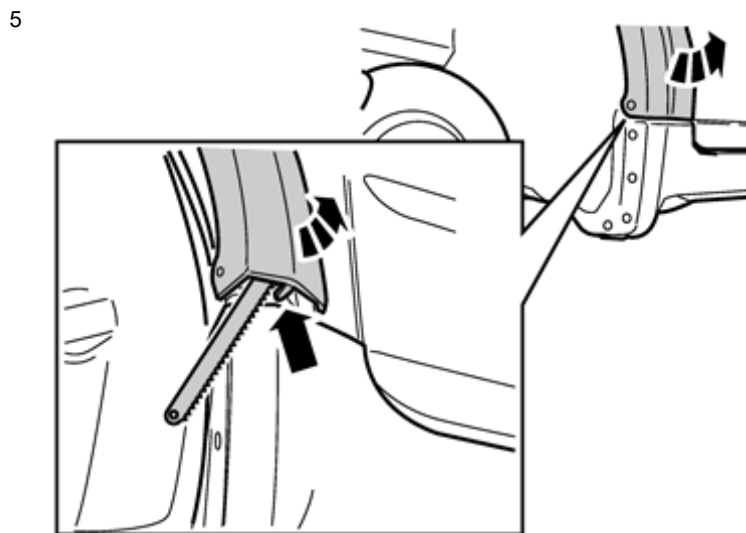
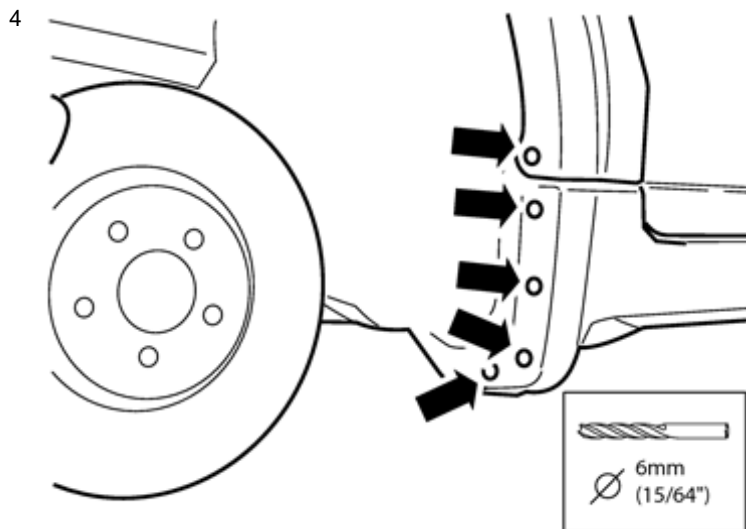

Installation instructions, accessories

Volvo Car Corporation Gothenburg, Sweden

6

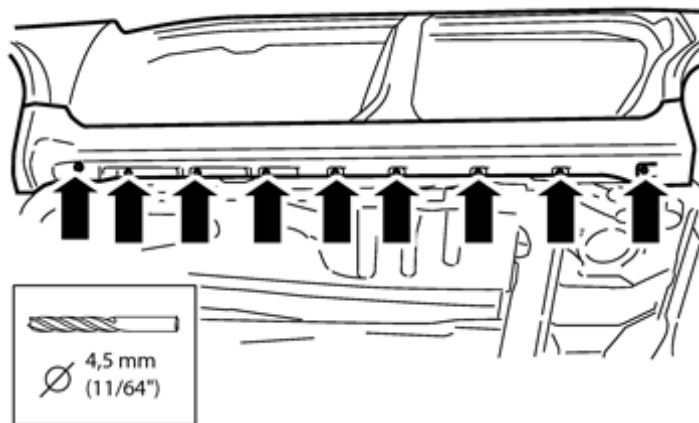

Drill out the central pins in the clips at the lower edge of the door sill panel and remove them. Use a Ø4.5 mm (11/64")

IMG-265390

7

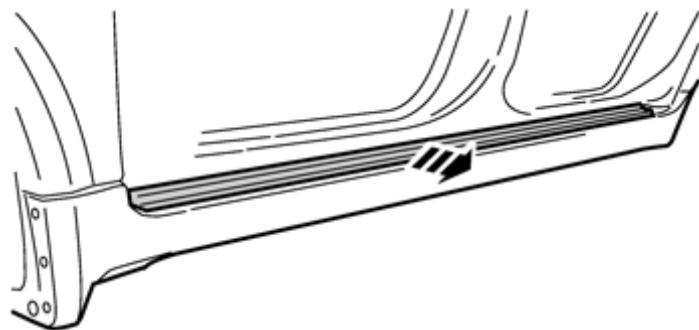

Remove the rubber strip.

IMG-265391

Installation instructions, accessories

Volvo Car Corporation Gothenburg, Sweden

8

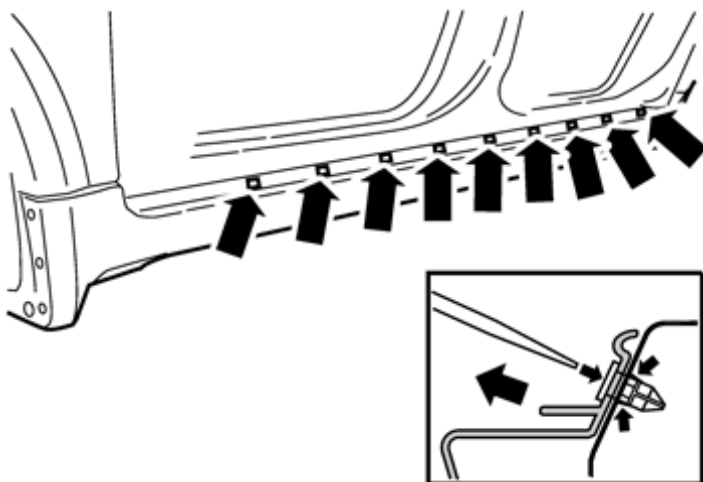

IMG-265392

Insert a large flat-bladed screwdriver, press the bottom of the clips and pull off the door sill panel with the clips.

9

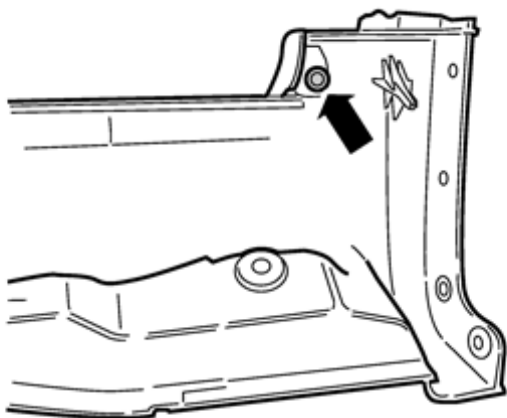

IMG-265393

Detach the door sill panel's front end. It is secured by a clip.

Installation instructions, accessories

Volvo Car Corporation Gothenburg, Sweden

10

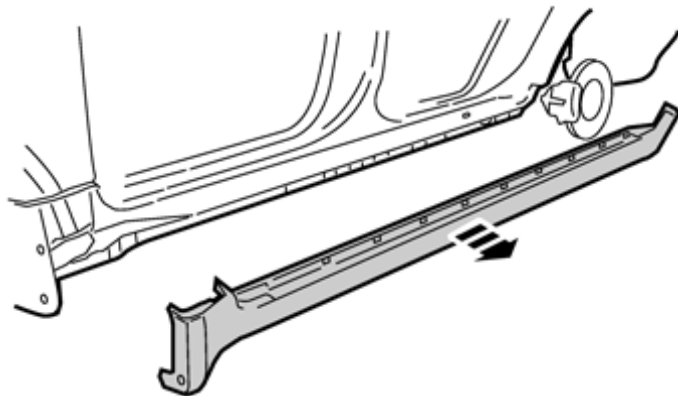

Remove the panel from the body. It will not be reused.

IMG-265394

Installation

11

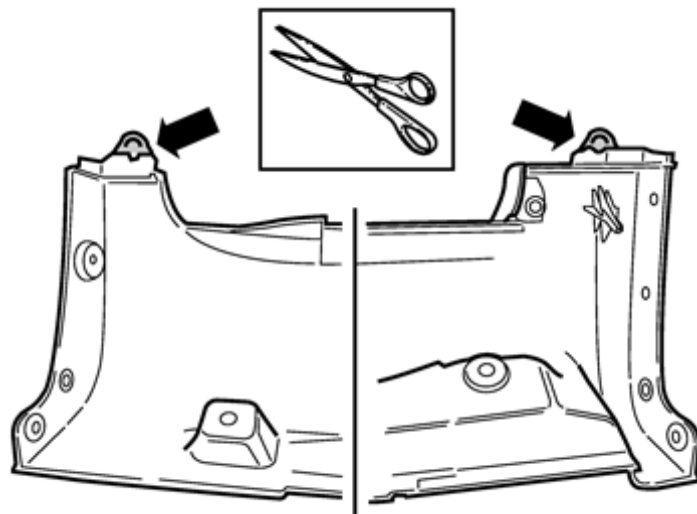

Installation

Take a new panel from the kit. Cut off the mounting eyelets on top of the upper sides.

IMG-265395

Installation instructions, accessories

Volvo Car Corporation Gothenburg, Sweden

12

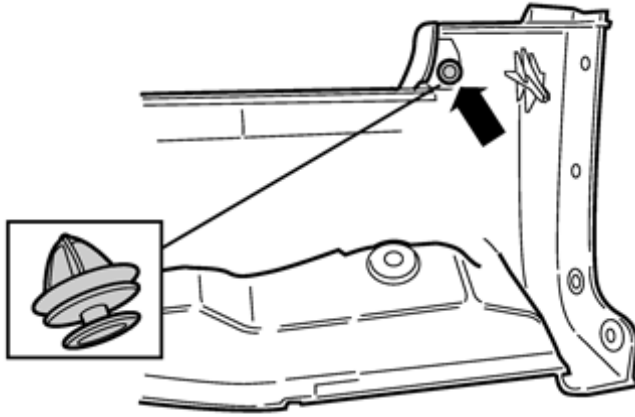

Install a new clip.

IMG-265396

13

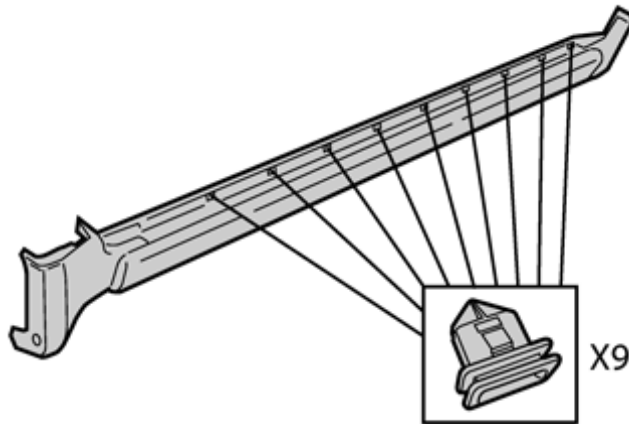

Install new clips.

IMG-265397

Installation instructions, accessories

Volvo Car Corporation Gothenburg, Sweden

14

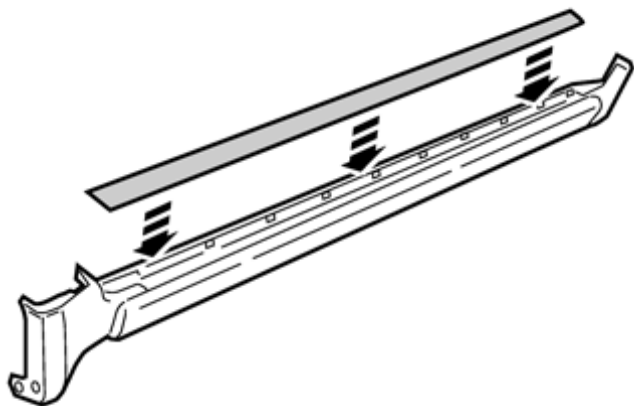

Press the rubber strip onto the new panel.

IMG-265398

15

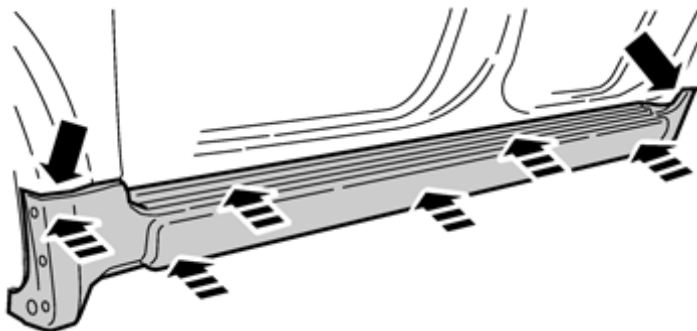

Align the door sill panel ends under the wing extenders.

Press the front section clips into place.

Press the panel with the rubber strip along the body side.
Ensure that all clips engage and that the rubber strip is correctly positioned.

IMG-265399

Installation instructions, accessories

Volvo Car Corporation Gothenburg, Sweden

16

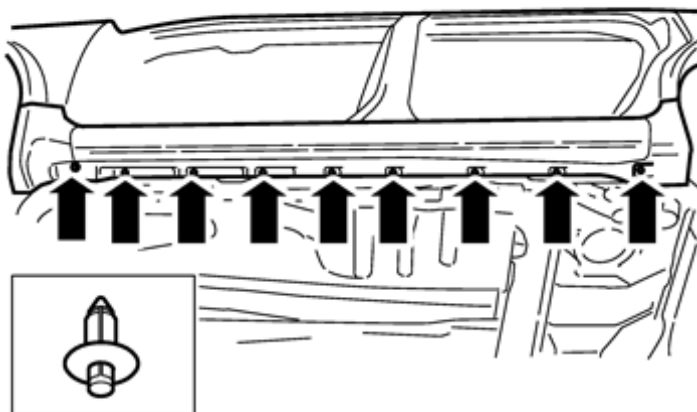

Press the panel into place in the lower edge using new clips.

IMG-265400

17

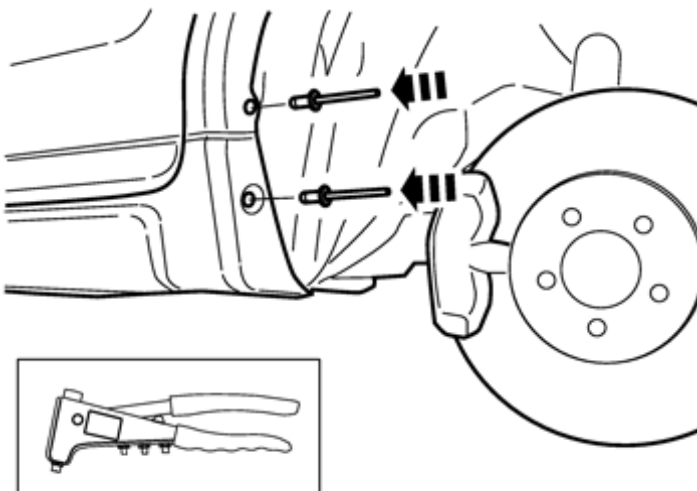

Pop rivet the panels into place.

IMG-265401

Installation instructions, accessories

Volvo Car Corporation Gothenburg, Sweden

18

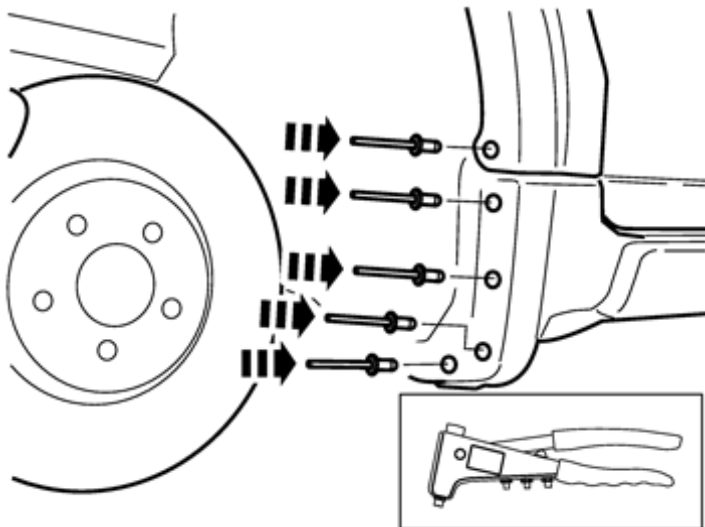

IMG-265402

Pop rivet the panels into place.

19

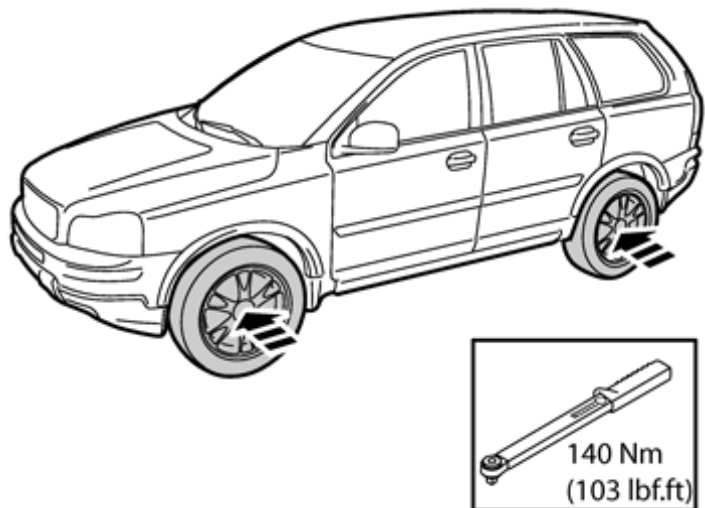

IMG-265403

Reinstall the front and rear wheels.

Repeat all steps for the other side.