



Installation instructions, accessories

Volvo Car Corporation Gothenburg, Sweden

Instruction No
31269640

Version
1.0

Part. No.
31265336, 31359685

Mudflaps, rear



Installation instructions, accessories

Volvo Car Corporation Gothenburg, Sweden

Equipment

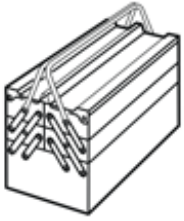

A0000162

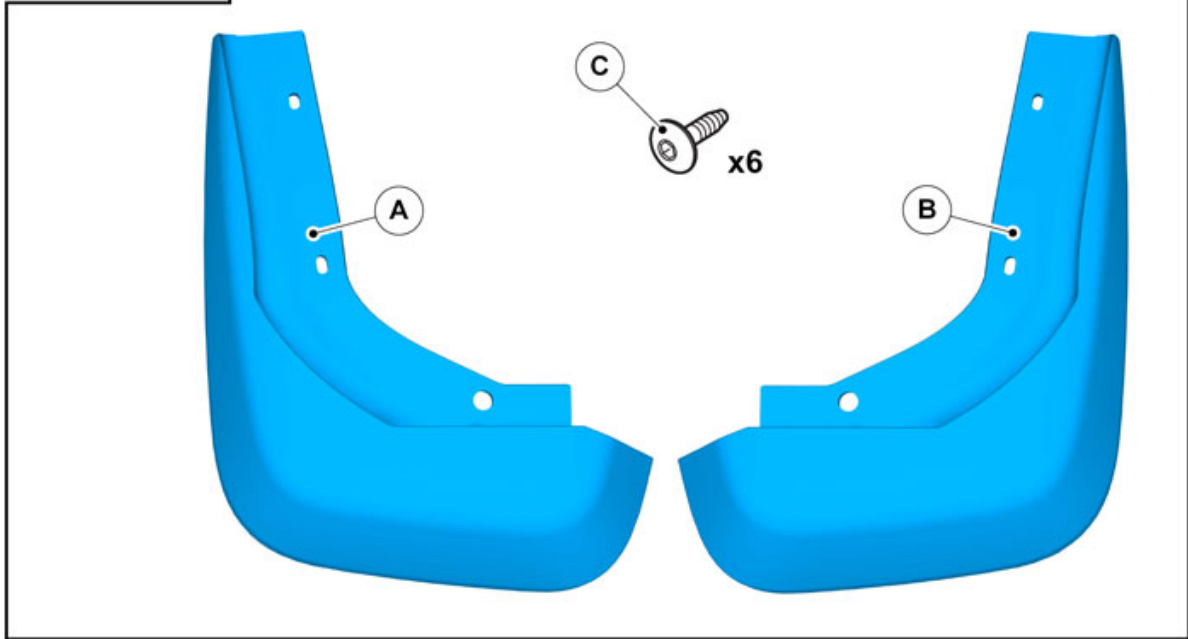

IMG-340377



Installation instructions, accessories

Volvo Car Corporation Gothenburg, Sweden

INTRODUCTION

Read through all of the instructions before starting installation.

Notifications and warning texts are for your safety and to minimise the risk of something breaking during installation.

Ensure that all tools stated in the instructions are available before starting installation.

Certain steps in the instructions are only presented in the form of images. Explanatory text is also given for more complicated steps.

In the event of any problems with the instructions or the accessory, contact your local Volvo dealer.

1

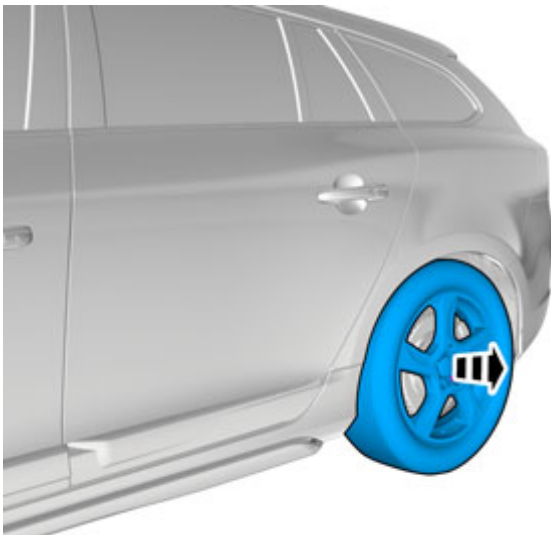

IMG-340375

Remove the wheel.

2

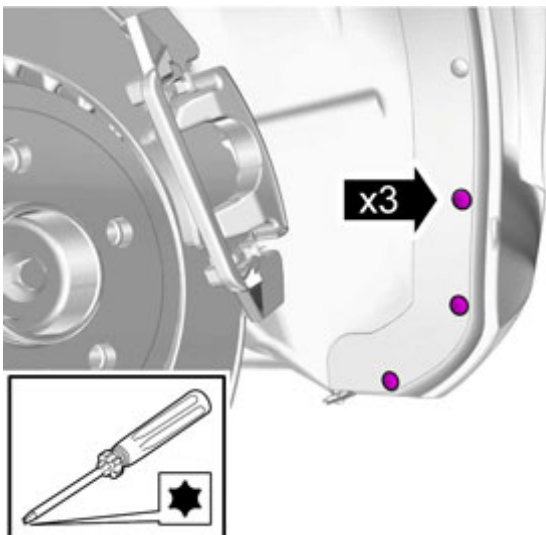

IMG-340378

Remove the screws. These will not be reused.



Installation instructions, accessories

Volvo Car Corporation Gothenburg, Sweden

3

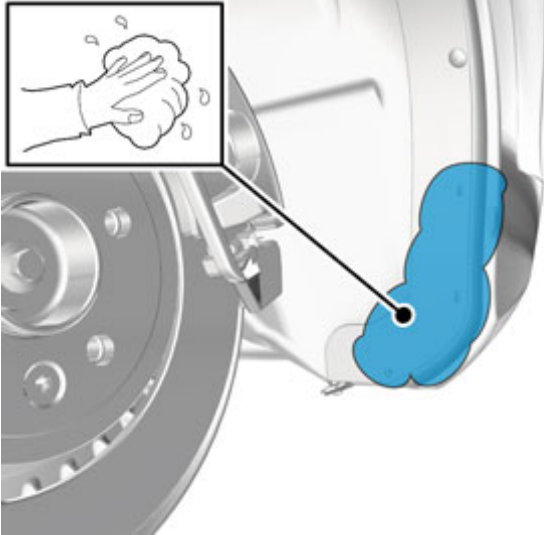

IMG-340379

Clean the area where the mudflap is to be positioned.

4

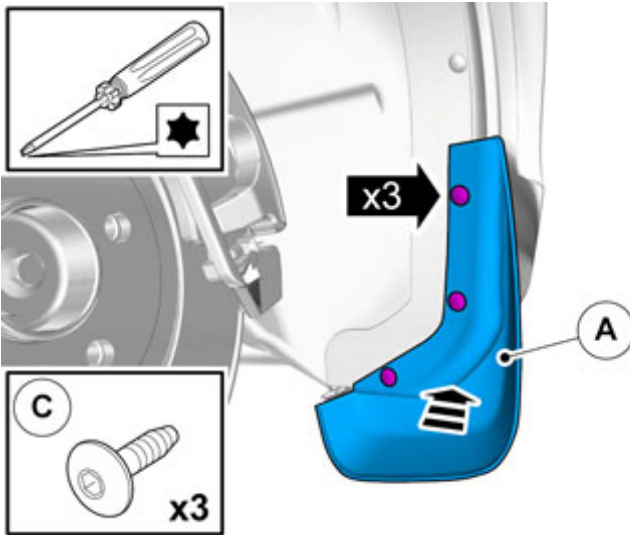

IMG-340381

Install and screw the mudflap into place.



Installation instructions, accessories

Volvo Car Corporation Gothenburg, Sweden

5

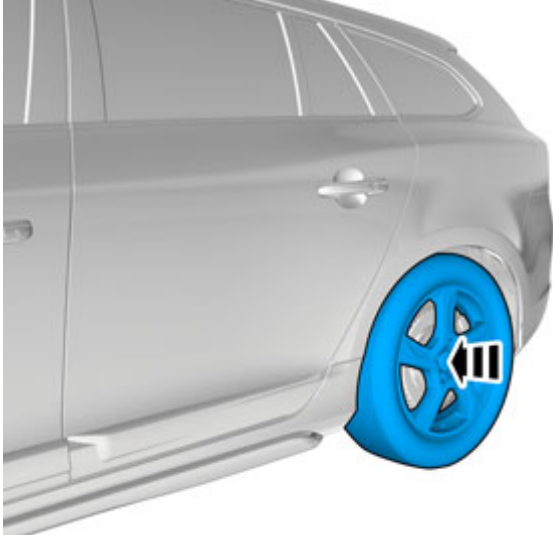

IMG-340376

Reinstall the wheel.

Tightening torque: 140 Nm

Repeat the method steps for the other side.