

Installation instructions, accessories

Volvo Car Corporation Gothenburg, Sweden

Instruction No	Version	Part. No.
30660681	1.0	

Radio HU

Equipment

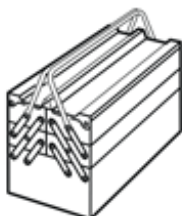

A0000162



A0801178

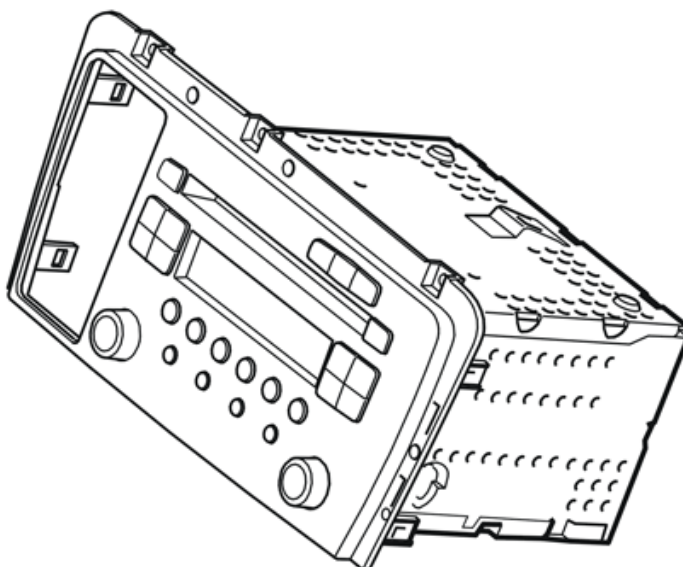

M3905104

Installation instructions, accessories

Volvo Car Corporation Gothenburg, Sweden

INTRODUCTION

Read through all of the instructions before starting installation.

Notifications and warning texts are for your safety and to minimise the risk of something breaking during installation.

Ensure that all tools stated in the instructions are available before starting installation.

Certain steps in the instructions are only presented in the form of images. Explanatory text is also given for more complicated steps.

In the event of any problems with the instructions or the accessory, contact your local Volvo dealer.

Note!

This accessory is connected to the electrical system of the car. It requires software unique to the car.

1

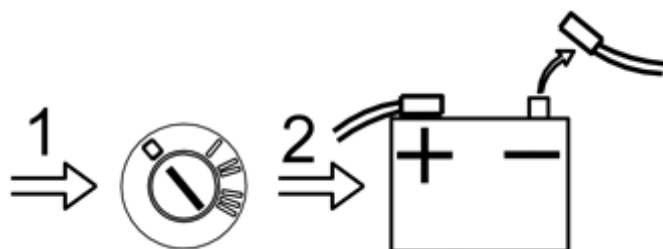

A8800136

Applies to cars with automatic gearboxes

Turn the ignition key to position 0.

Note!

Wait at least five minutes before disconnecting the connectors or removing other electrical equipment.

Disconnect the battery negative lead.

Applies to cars with manual gearboxes

Turn the ignition key to position 0. Remove the ignition key from the ignition switch.

Note!

Wait at least five minutes before disconnecting the connectors or removing other electrical equipment.

Installation instructions, accessories

Volvo Car Corporation Gothenburg, Sweden

2

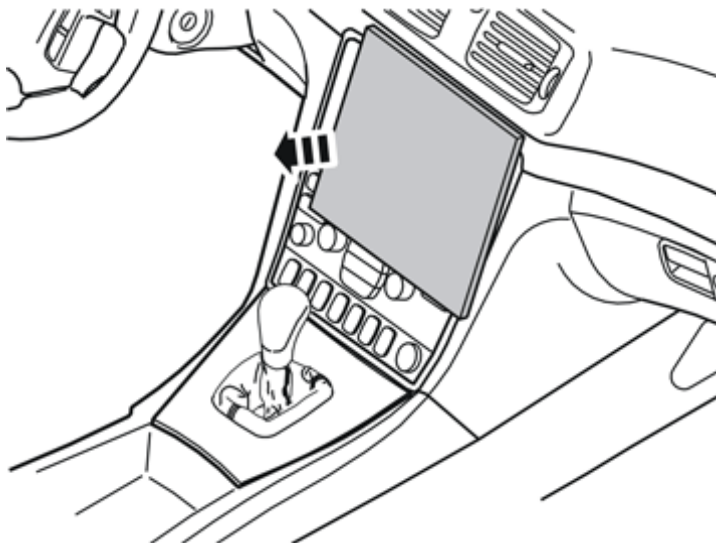

M8504991

Remove the polystyrene block from the centre console. It will not be reused.

3

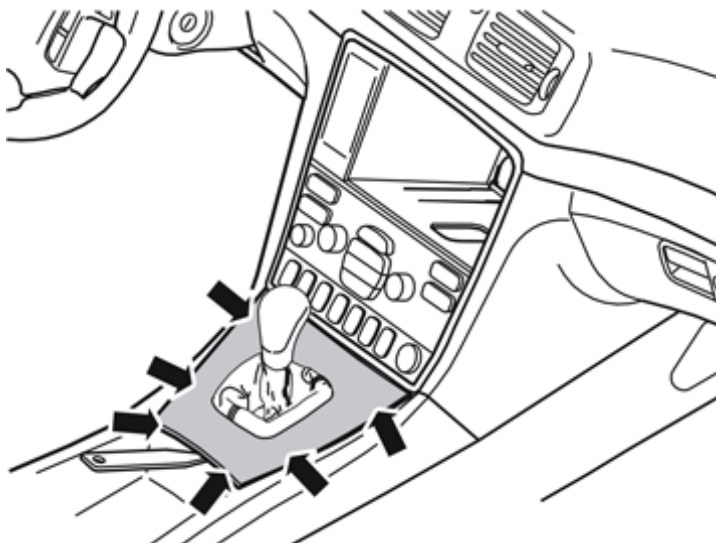

M8504992

Detach the rear edge of the gear selector lever cover together with the boot until the two clips release. Use a plastic weatherstrip tool. Remove the gear selector lever cover and the boot. Pull the panel up until the four clips at the sides release.

Installation instructions, accessories

Volvo Car Corporation Gothenburg, Sweden

4

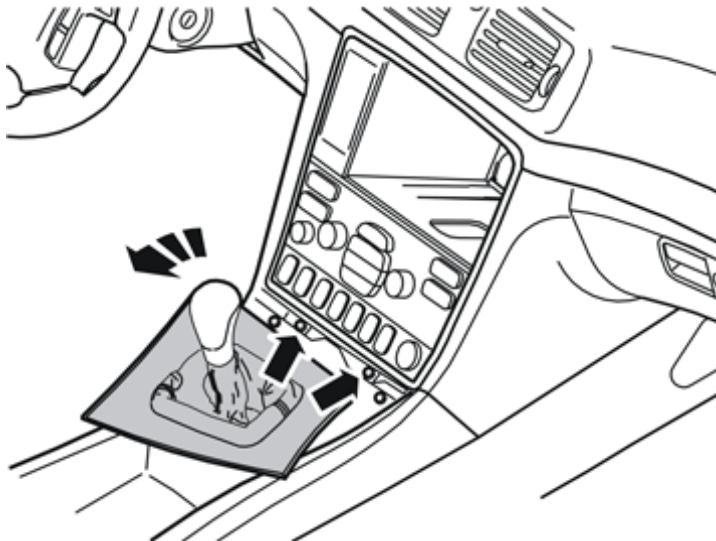

M8504993

Apply the handbrake. Move the gear selector backwards

Turn the panel to the left to facilitate access

Remove the two screws holding the bracket with the radio and the dashboard environment panel in the centre console.

5

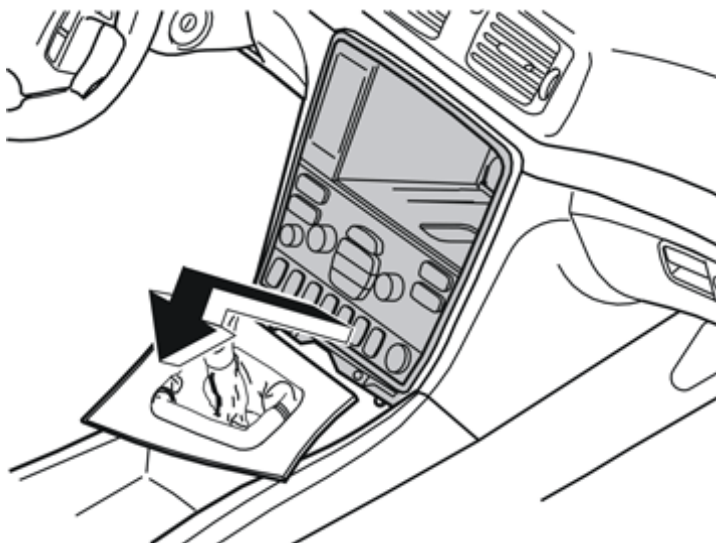

M8504994

Remove the bracket with dashboard environment panel from the centre console: Pull the lower edge out and downwards until it releases from the mounting at the upper edge. Then fold backwards.

Note!

Do not damage the removed components and surrounding panels.

If necessary, remove the panel around the gear selector lever to gain more space. The panel is secured by four catches on the lower side at the boot.

Remove the connectors from the dashboard environment panel. Disconnect the connector for the phone if installed.

Installation instructions, accessories

Volvo Car Corporation Gothenburg, Sweden

6

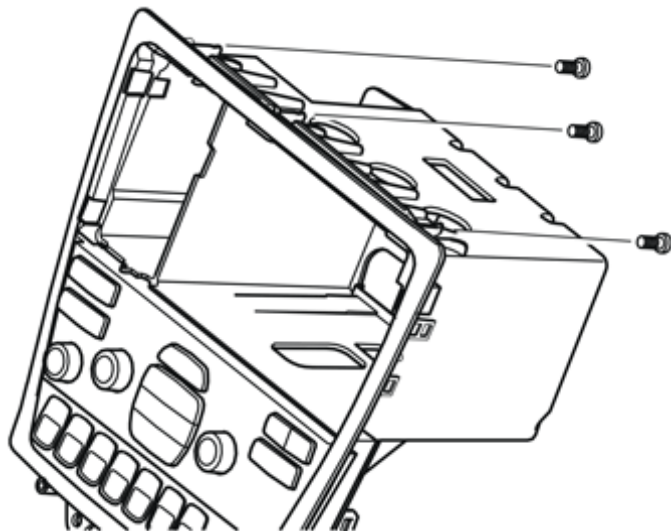

M3905098

Remove the three screws in the upper edge of the trim for the unit and radio and dashboard environment panel.

7

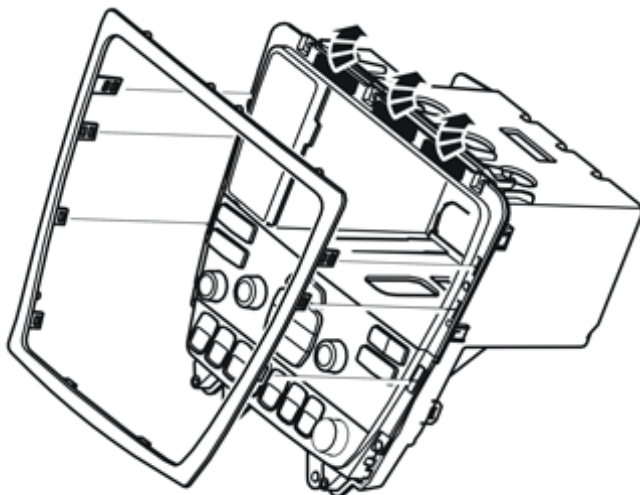

M3905105

Remove the trim from the unit. Pry off the catches along the vertical and lower sides of the trim. Pull off the trim. Do not damage the catches. The catches are thin and easily broken

Remove the three pieces of foam tape from the centre console. They will not be reused.

Installation instructions, accessories

Volvo Car Corporation Gothenburg, Sweden

8

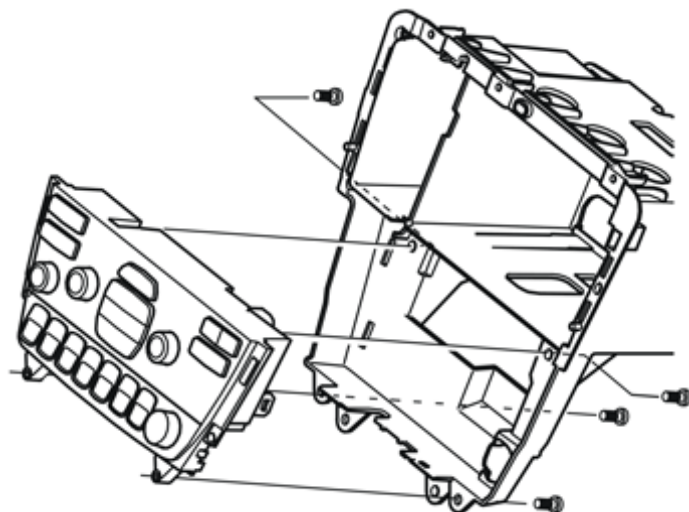

Remove the four screws on the reverse of the dashboard environment panel. Remove the dashboard environment panel from the bracket.

M3905106

9

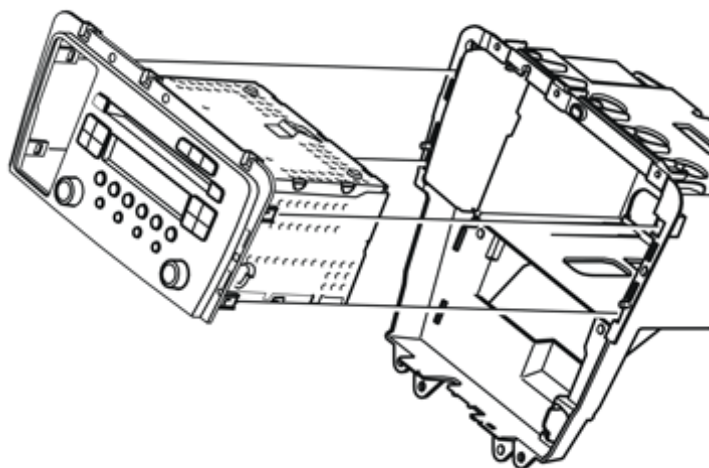

Take the radio from the kit. Press the radio into place in the bracket. Ensure that all the four catches on the sides engage.

M3904991

Installation instructions, accessories

Volvo Car Corporation Gothenburg, Sweden

10

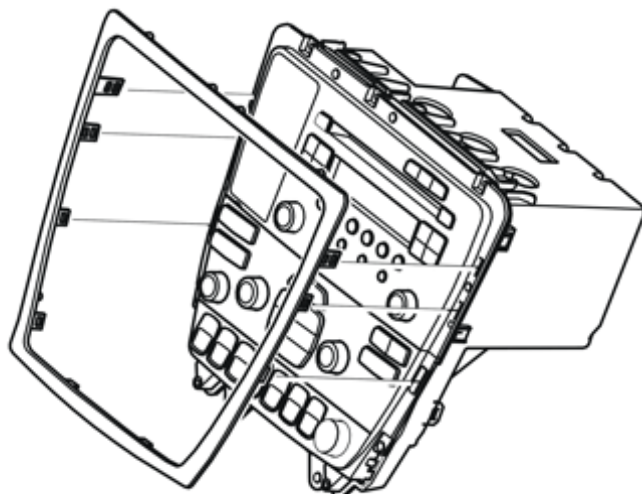

M3904990

Reinstall the dashboard environment panel in the bracket. Use 4 x screws

Reinstall the trim around the unit. Use 3 x screws in the upper edge.

11

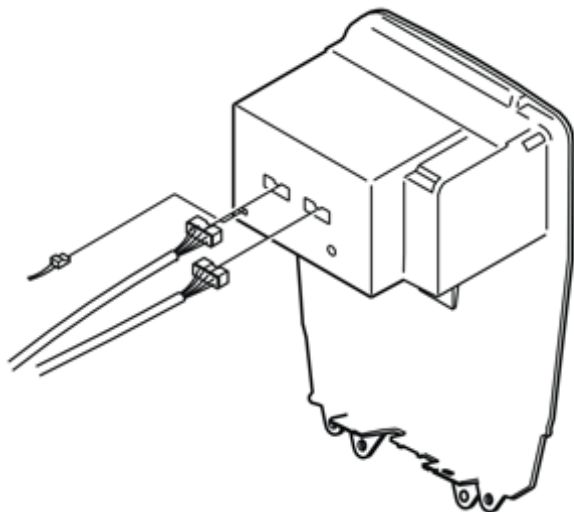

M3905045

Reconnect the connector for the phone, if installed

Connect the connectors to the dashboard environment panel

Connect the two large or single large (depending on version) pre-routed connector(s) to the radio

Connect the pre-routed antenna connector to the radio

Reinstall the unit in the centre console. Tighten the centre console. Use the two screws

Reinstall the panel around the gear selector lever

Connect the battery negative lead

Program the software according to the service information in VIDA.