

# Installation instructions, accessories

Volvo Car Corporation Gothenburg, Sweden

**Instruction No** 32261960    **Version** 1.0    **Part. No.** 32261953, 32261954

## Tablet holder (tablet without charging)

### Equipment

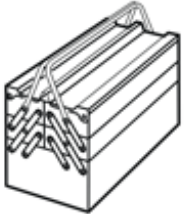

A0000162

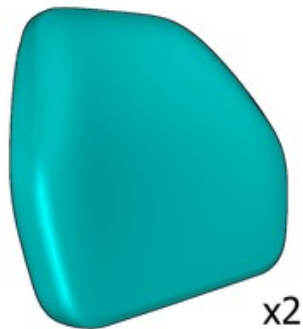

x2



x2

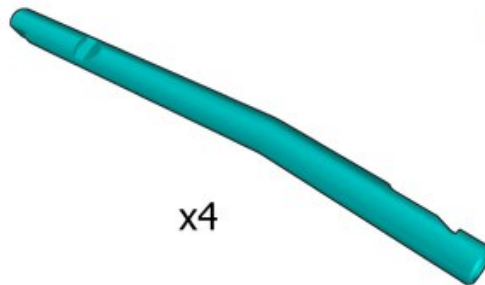

x4

IMG-462909

# Installation instructions, accessories

Volvo Car Corporation Gothenburg, Sweden

## Information

1

Read through all of the instructions before starting installation.

Notifications and warning texts are for your safety and to minimise the risk of something breaking during installation.

Ensure that all tools stated in the instructions are available before starting installation.

Certain steps in the instructions are only presented in the form of images. Explanatory text is also given for more complicated steps.

In the event of any problems with the instructions or the accessory, contact your local Volvo dealer.

## Further information

2

There may be parts in the accessories kit that are not needed for this installation.

## Color symbols

3

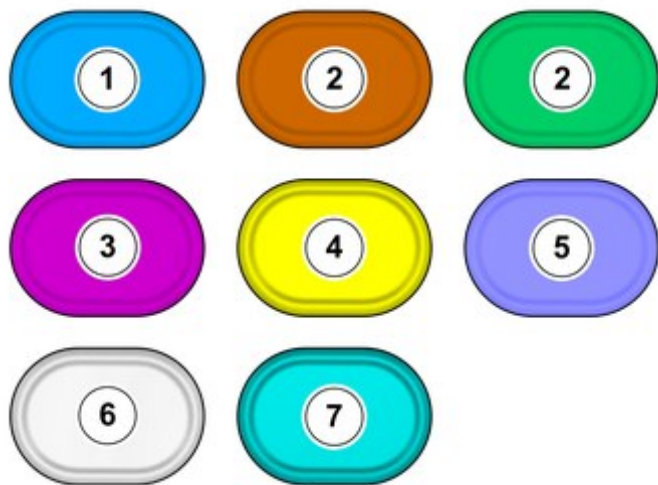

IMG-440436

### Note!

This colour chart displays (in colour print and electronic version) the importance of the different colours used in the images of the method steps.

1. Used for focused component, the component with which you will do something.
2. Used as extra colors when you need to show or differentiate additional parts.
3. Used for attachments that are to be removed/installed. May be screws, clips, connectors, etc.
4. Used when the component is not fully removed from the vehicle but only hung to the side.
5. Used for standard tools and special tools.
6. Used as background color for vehicle components.
7. Used for accessory components.

## Removal

4

### Note!

The removal steps may contain installation details.

# Installation instructions, accessories

Volvo Car Corporation Gothenburg, Sweden

5

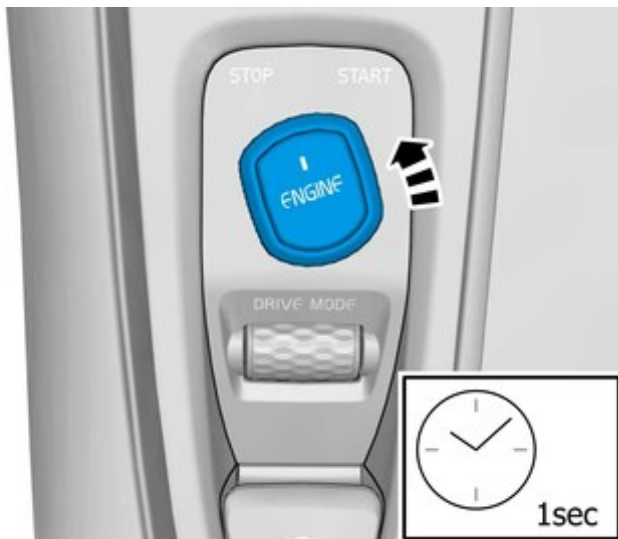

IMG-394535

6



IMG-394500

Move marked component forward.

# Installation instructions, accessories

Volvo Car Corporation Gothenburg, Sweden

7



**Note!**  
Orientation view

IMG-462934

8

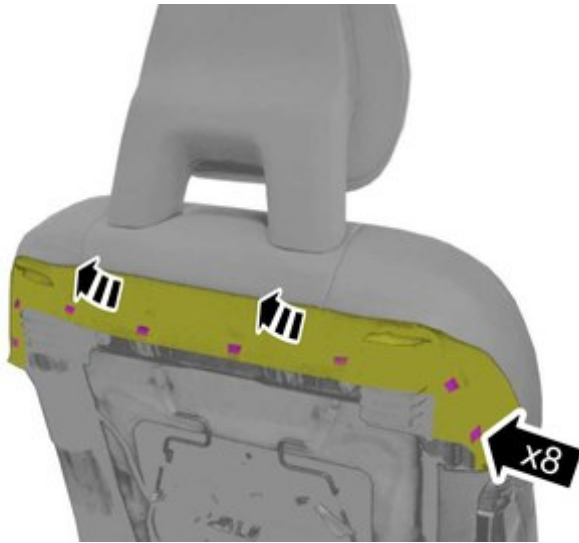

Fold marked part aside.

IMG-462933

# Installation instructions, accessories

Volvo Car Corporation Gothenburg, Sweden

9

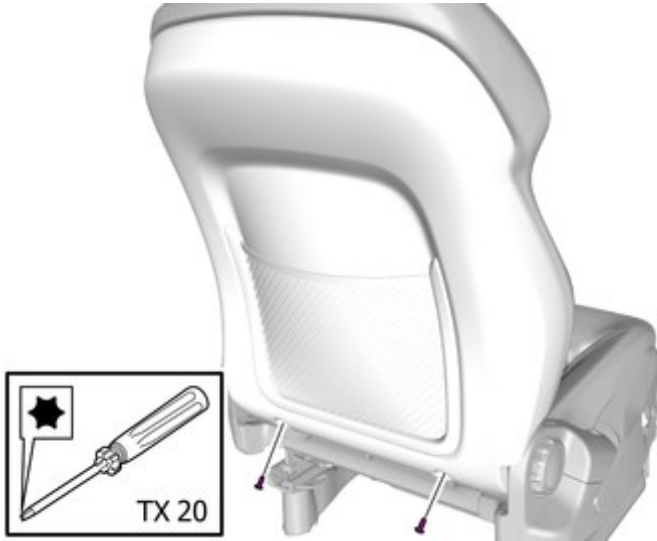

IMG-394038

Remove the screws.

10

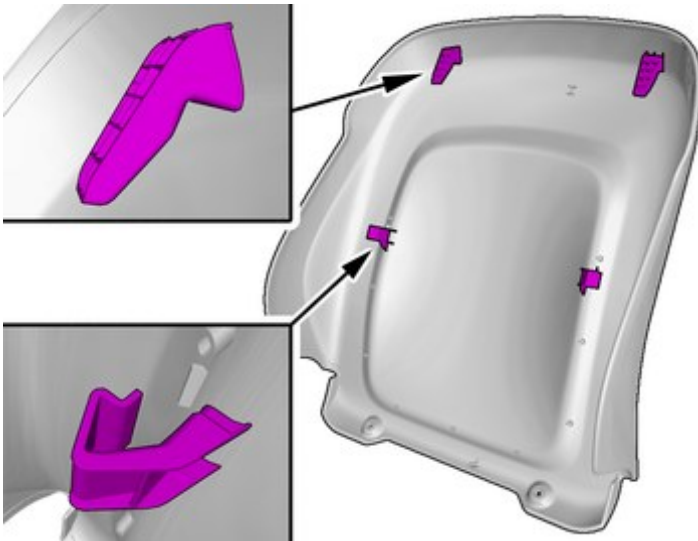

IMG-394018

**Note!**  
The graphic shows the back of the component before removal.

# Installation instructions, accessories

Volvo Car Corporation Gothenburg, Sweden

11

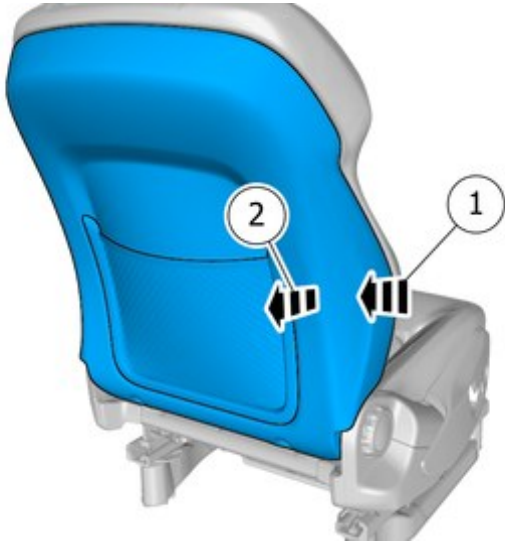

**Note!**

Perform the procedure one side at a time.

IMG-394039

12

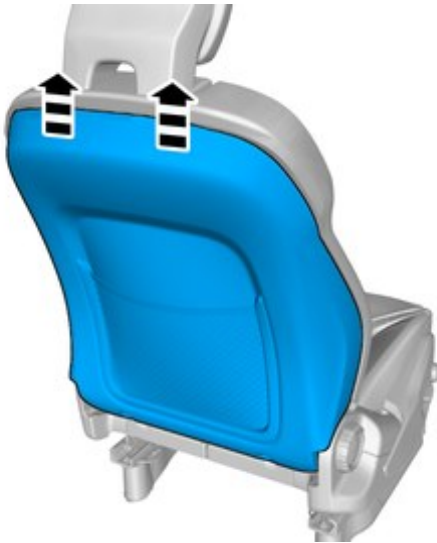

Remove the marked part.

IMG-462177

# Installation instructions, accessories

Volvo Car Corporation Gothenburg, Sweden

13

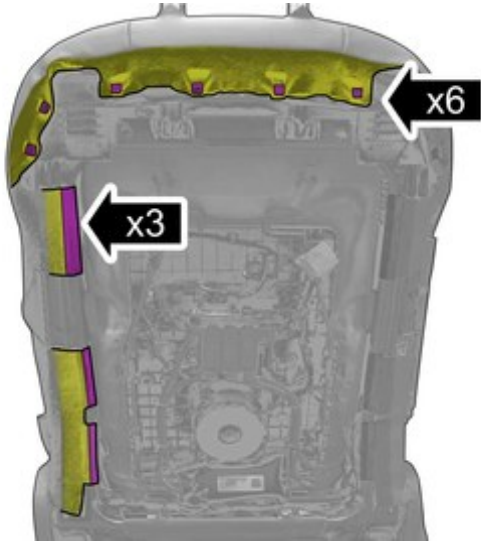

IMG-399420

14

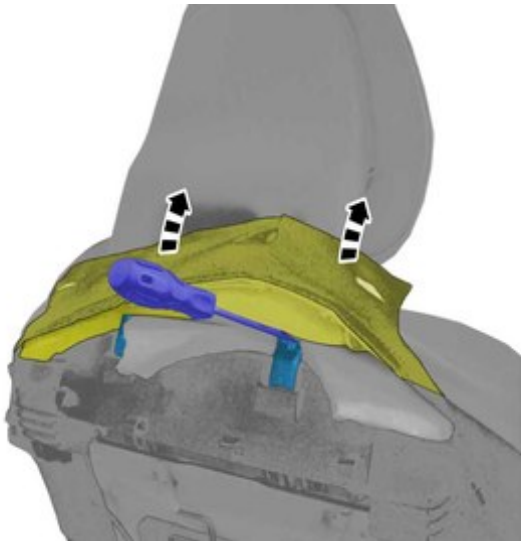

IMG-462935

# Installation instructions, accessories

Volvo Car Corporation Gothenburg, Sweden

15

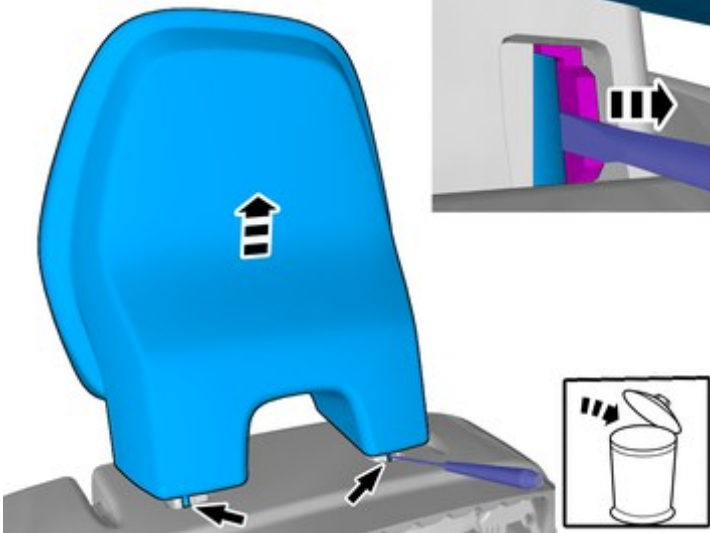

IMG-462059

The image shows seat without upholstery.

Release the locks.

Remove the marked part.

## Accessory installation

16

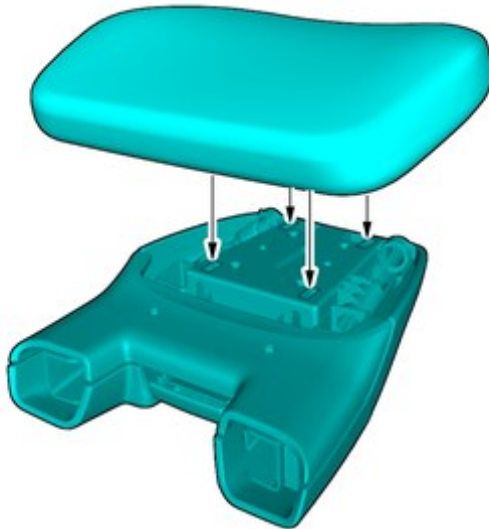

IMG-462911

Assemble components that come with the accessory kit.

A click confirms that the component is in the correct position.



# Installation instructions, accessories

Volvo Car Corporation Gothenburg, Sweden

17

Assemble components that come with the accessory kit.

Repeat the steps when installing accessories on opposite side.

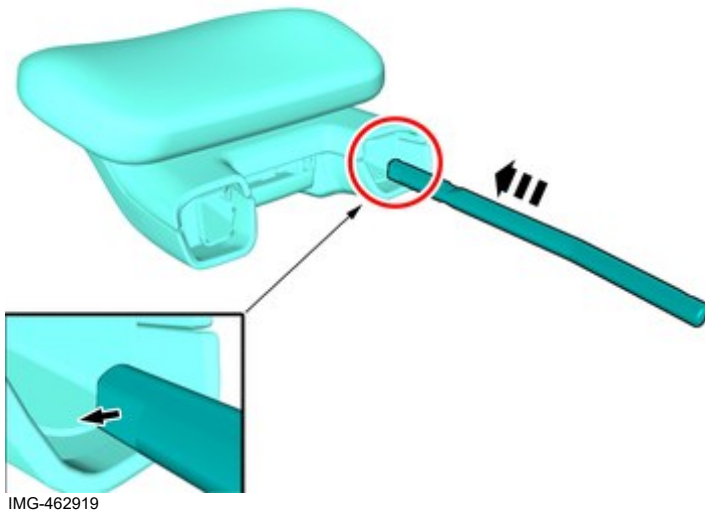

18

**Note!**  
The image shows head restraint without cushion.

Check that the component has locked in its position.

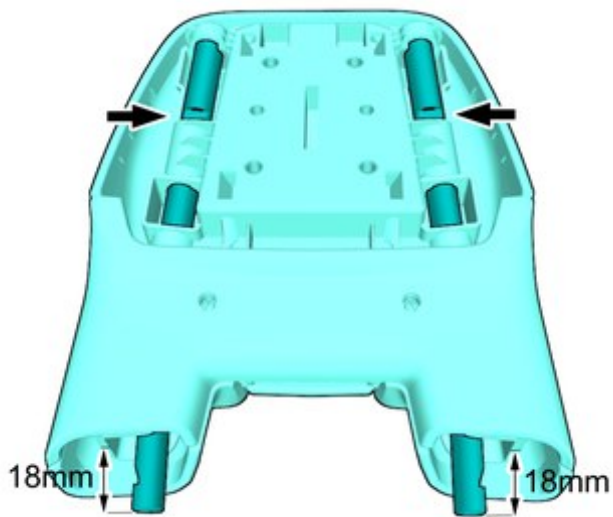

# Installation instructions, accessories

Volvo Car Corporation Gothenburg, Sweden

19



IMG-462922

**Caution!**

Check that the component has locked in its bottom position.

20

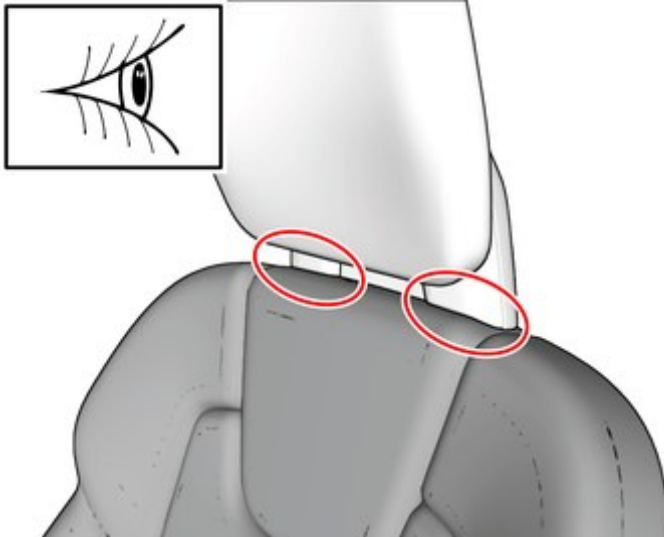

IMG-459273

**Note!**

Make sure that the backrest upholstery touches the head restraint, showing no space in between.

Compare with upholstery and head restraint on the other front seat.

# Installation instructions, accessories

Volvo Car Corporation Gothenburg, Sweden

21

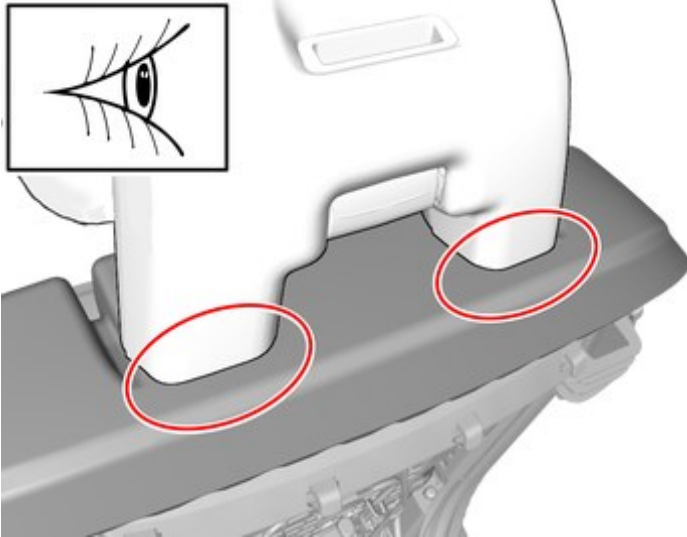

IMG-462926

**Note!**

Make sure that the backrest upholstery touches the head restraint, showing no space in between.

Compare with upholstery and head restraint on the other front seat.

If adjustment is necessary, follow the procedure described in the method step below.

22

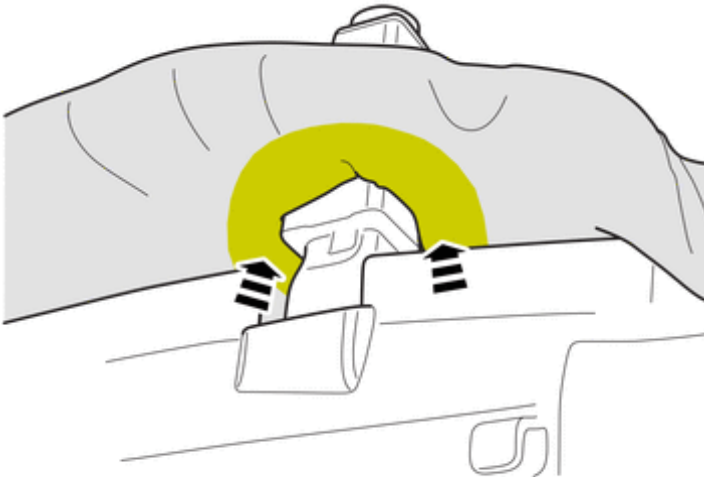

IMG-407341

**Caution!**

Press the foam padding upward against the upholstery.

## Installation

23

Reinstall the removed parts in reverse order.

24

Repeat the steps when removing on opposite side.

Repeat the steps when installing accessories on opposite side.