

Installation instructions, accessories

Volvo Car Corporation Gothenburg, Sweden

Instruction No	Version	Part. No.
31439267	1.1	31470165, 31659718

Sport pedals

Equipment



IMG-239667

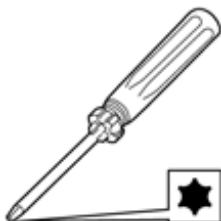

IMG-263203

A

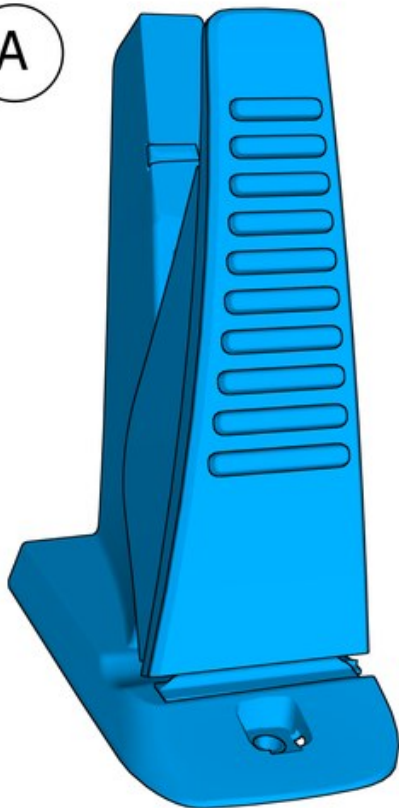

IMG-394219

B



Installation instructions, accessories

Volvo Car Corporation Gothenburg, Sweden

Information

1

Read through all of the instructions before starting installation.

Notifications and warning texts are for your safety and to minimise the risk of something breaking during installation.

Ensure that all tools stated in the instructions are available before starting installation.

Certain steps in the instructions are only presented in the form of images. Explanatory text is also given for more complicated steps.

In the event of any problems with the instructions or the accessory, contact your local Volvo dealer.

Color symbols

2

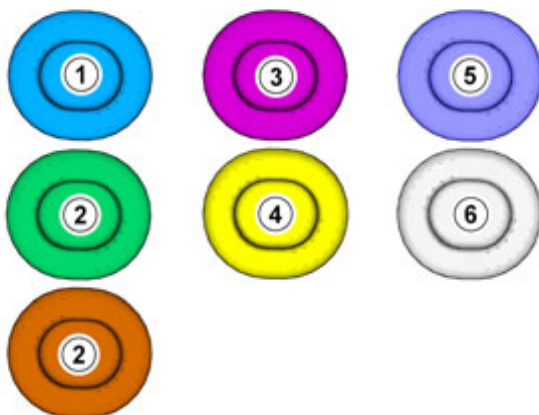

1. Used for focused component, the component with which you will do something.

2. Used as extra colors when you need to show or differentiate additional parts.

3. Used for attachments that are to be removed/installed. May be screws, clips, connectors, etc.

4. Used when the component is not fully removed from the vehicle but only hung to the side.

5. Used for standard tools and special tools.

6. Used as background color for vehicle components.

IMG-363036

Removal

Installation instructions, accessories

Volvo Car Corporation Gothenburg, Sweden

3

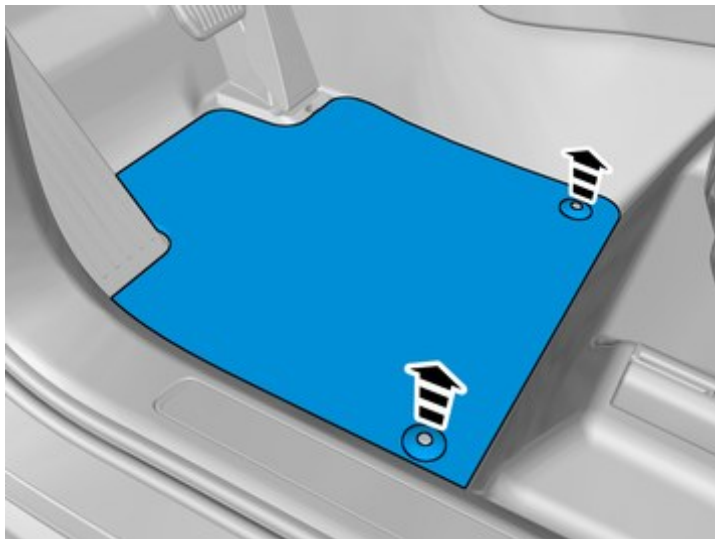

IMG-394087

Remove the marked part.

4

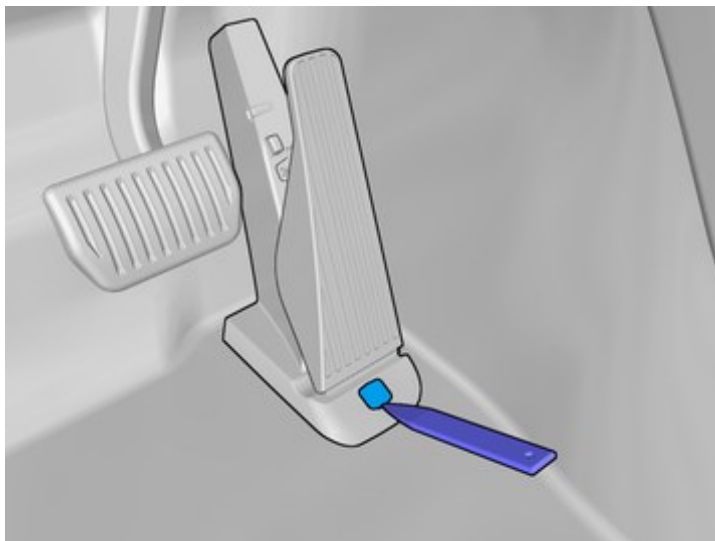

IMG-394096

Remove the marked part.

Use: Interior trim remover

The part is to be reused.

Installation instructions, accessories

Volvo Car Corporation Gothenburg, Sweden

5

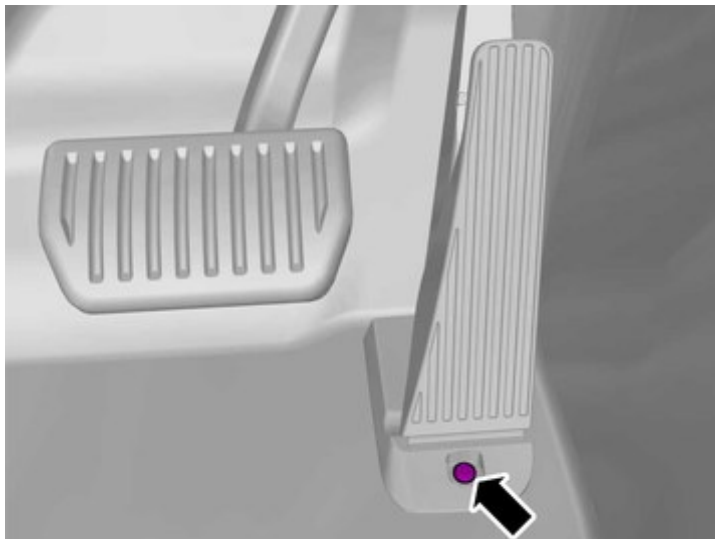

IMG-394081

Remove the screw.

The part is to be reused.

6

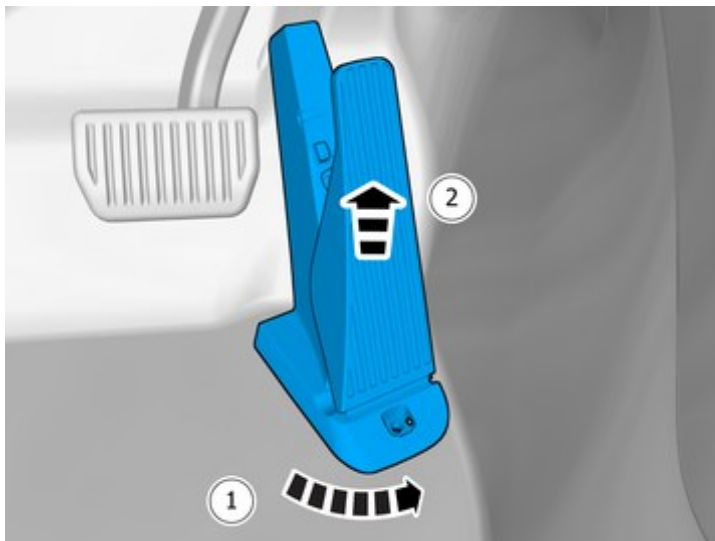

IMG-394105

Remove the marked part.

Installation instructions, accessories

Volvo Car Corporation Gothenburg, Sweden

7

Disconnect the connector.

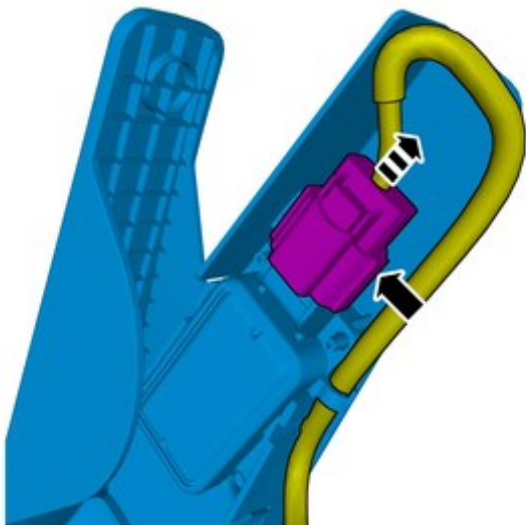

IMG-394078

8

Use: Interior trim remover

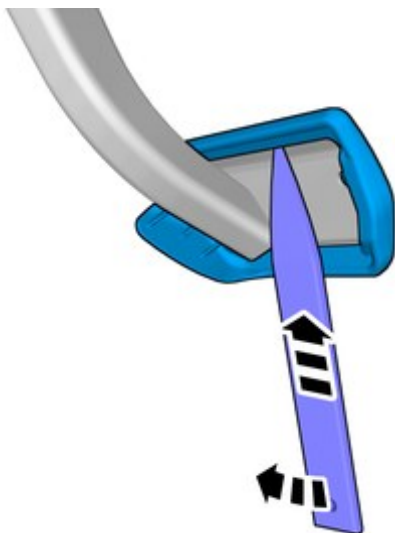

IMG-394180

Installation instructions, accessories

Volvo Car Corporation Gothenburg, Sweden

9

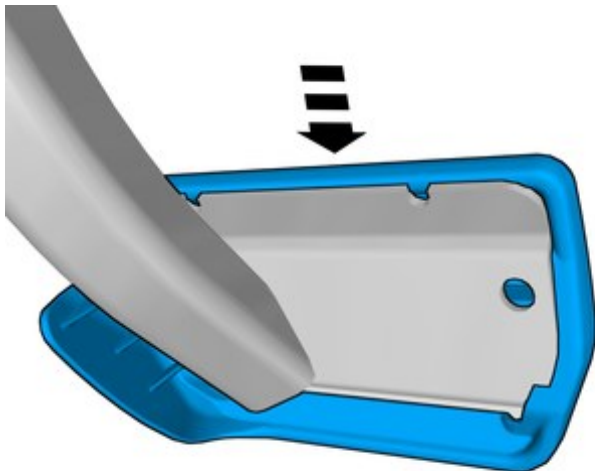

Remove the marked part.

IMG-394183

Accessory installation

10

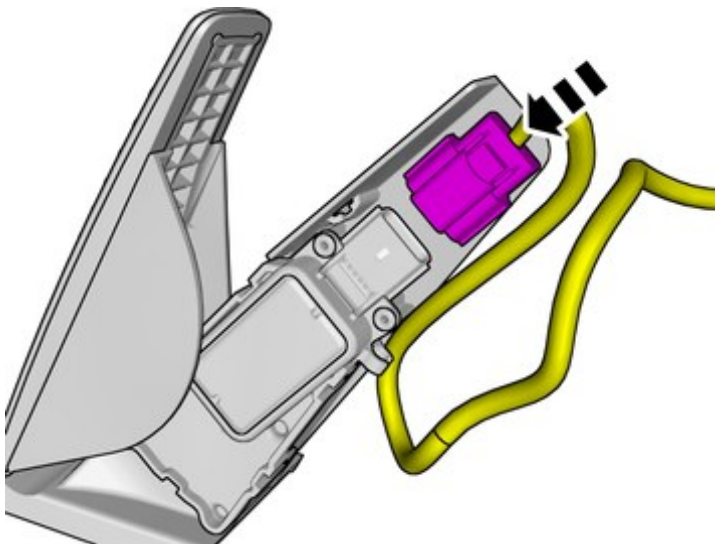

Connect the connector.

IMG-394218

Installation instructions, accessories

Volvo Car Corporation Gothenburg, Sweden

11

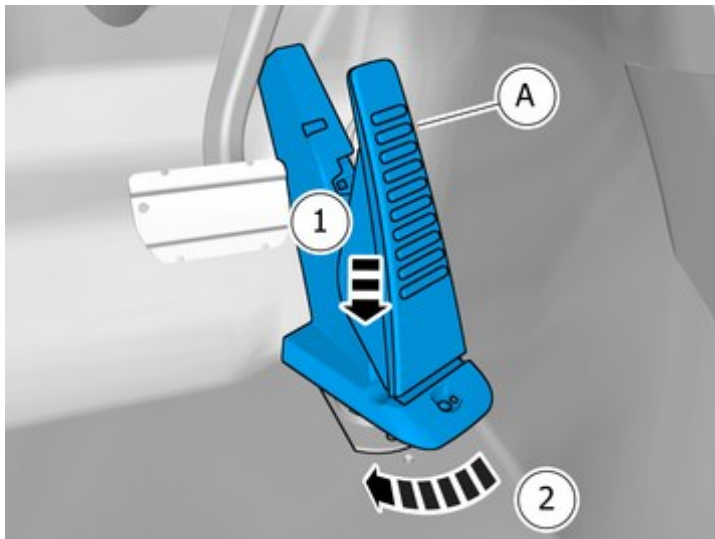

IMG-394155

Install component that comes with the accessory kit.

12

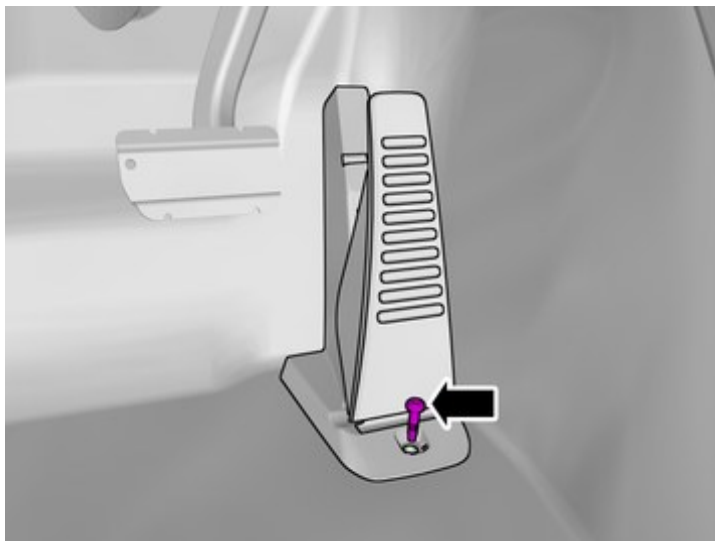

IMG-394160

Install the screw.

Tightening torque: Accelerator pedal, to Floor , 6.5 Nm

Installation instructions, accessories

Volvo Car Corporation Gothenburg, Sweden

13

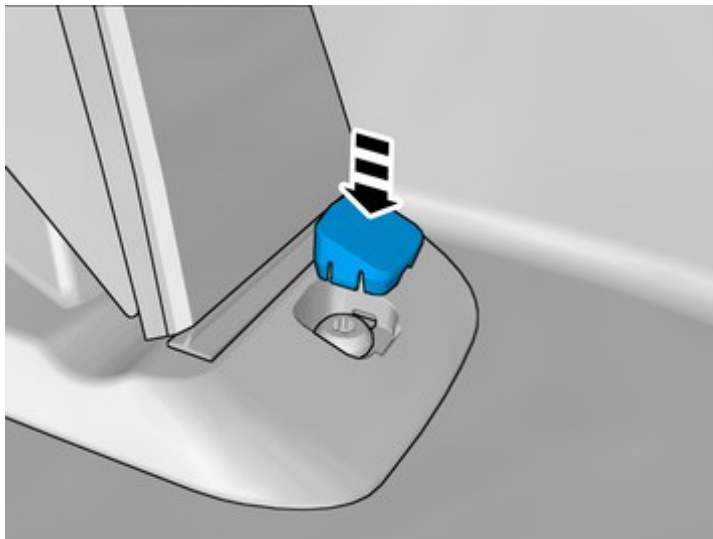

IMG-400536

Reinstall the removed part.

14

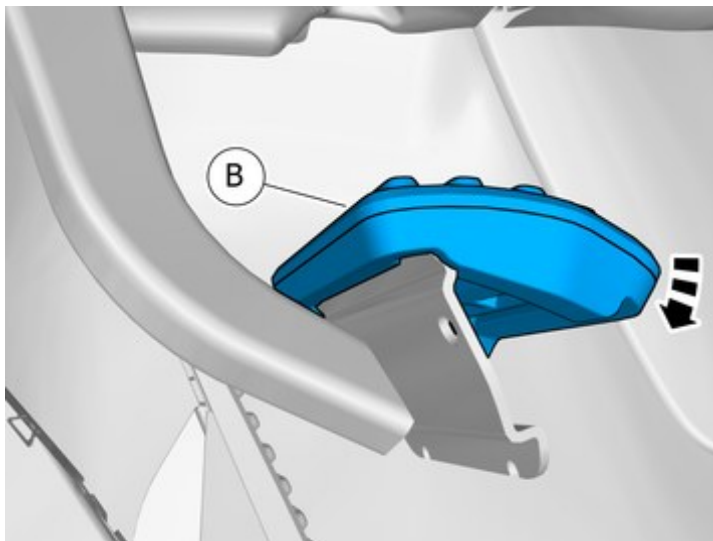

IMG-394215

Install component that comes with the accessory kit.

Installation instructions, accessories

Volvo Car Corporation Gothenburg, Sweden

15



Use: Interior trim remover

IMG-394216

16

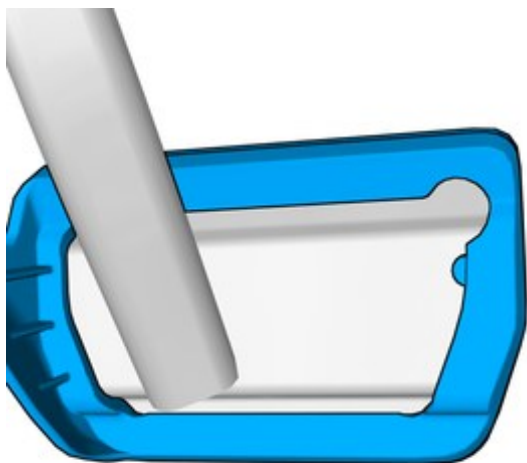

Note!
Orientation view

IMG-394225