

# Installation instructions, accessories

Volvo Car Corporation Gothenburg, Sweden

**Instruction No** 31338928  
**Version** 1.1  
**Part. No.** 31338926, 31338927

## Daytime Running Light LED

### Equipment

**VIDA**

IMG-242205

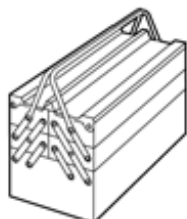

IMG-345497

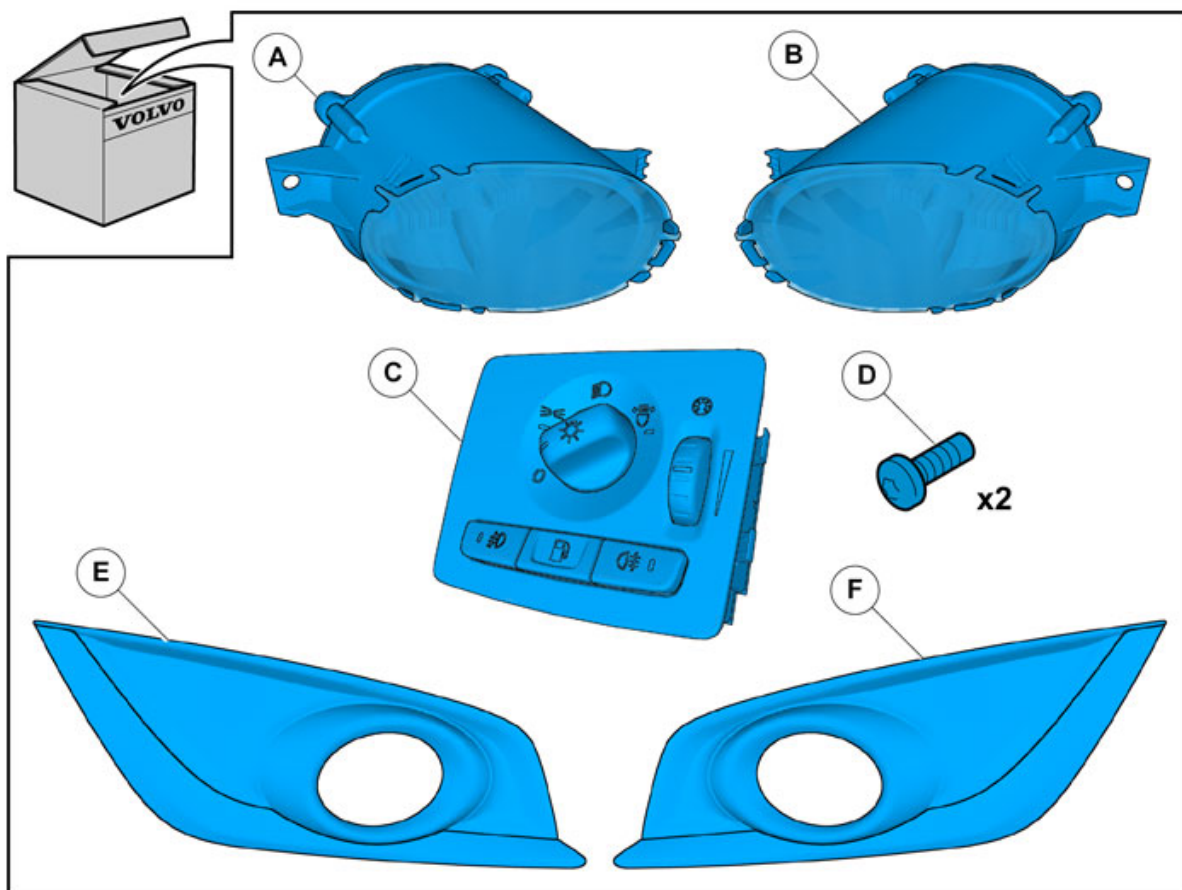

IMG-362000

# Installation instructions, accessories

Volvo Car Corporation Gothenburg, Sweden

---

## Information

---

1

Read through all of the instructions before starting installation.

Notifications and warning texts are for your safety and to minimise the risk of something breaking during installation.

Ensure that all tools stated in the instructions are available before starting installation.

Certain steps in the instructions are only presented in the form of images. Explanatory text is also given for more complicated steps.

In the event of any problems with the instructions or the accessory, contact your local Volvo dealer.

---

## Color symbols

---

2



IMG-363036

### Note!

This colour chart displays (in colour print and electronic version) the importance of the different colours used in the images of the method steps.

1. Used for focused component, the component with which you will do something.
  2. Used as extra colors when you need to show or differentiate additional parts.
  3. Used for attachments that are to be removed/installed. May be screws, clips, connectors, etc.
  4. Used when the component is not fully removed from the vehicle but only hung to the side.
  5. Used for standard tools and special tools.
  6. Used as background color for vehicle components.
- 

## Removal

---

# Installation instructions, accessories

Volvo Car Corporation Gothenburg, Sweden

3

Set the ignition key to position 0.

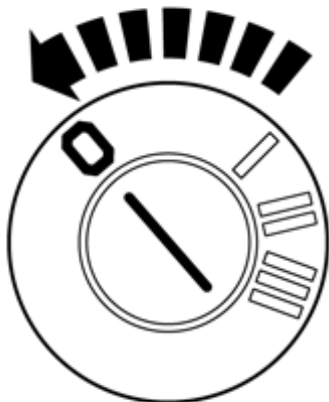

IMG-332193

4

Remove the panel.

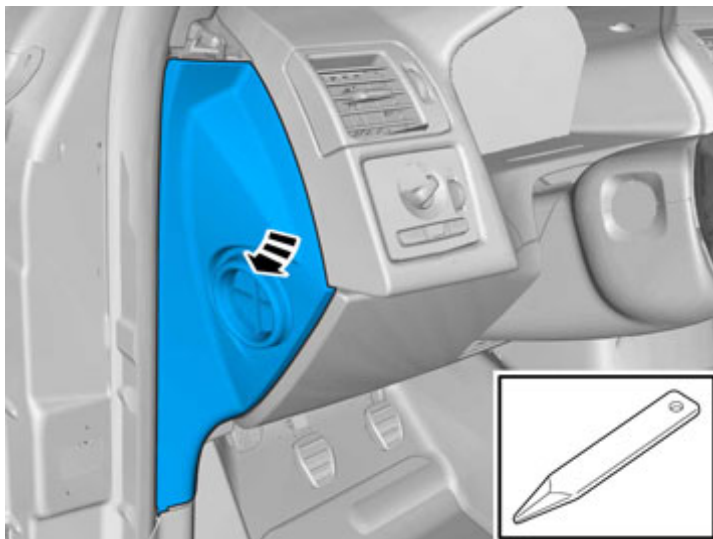

IMG-328423

# Installation instructions, accessories

Volvo Car Corporation Gothenburg, Sweden

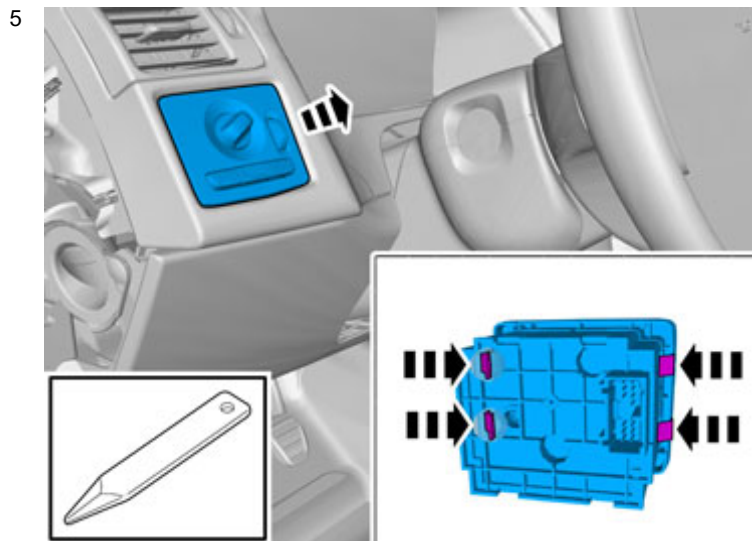

IMG-328424

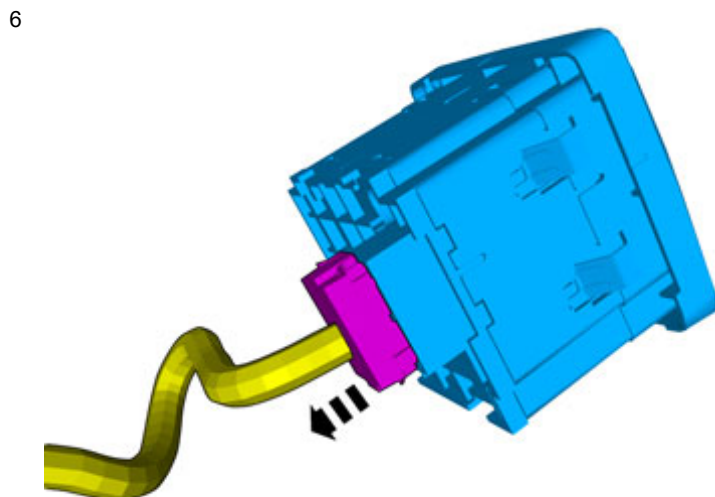

IMG-328425

Disconnect the connector.

**Accessory installation**

# Installation instructions, accessories

Volvo Car Corporation Gothenburg, Sweden

7

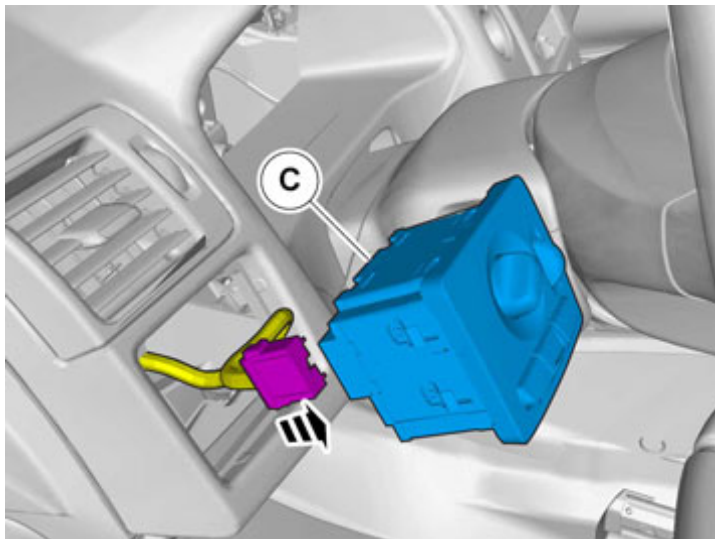

IMG-362003

8

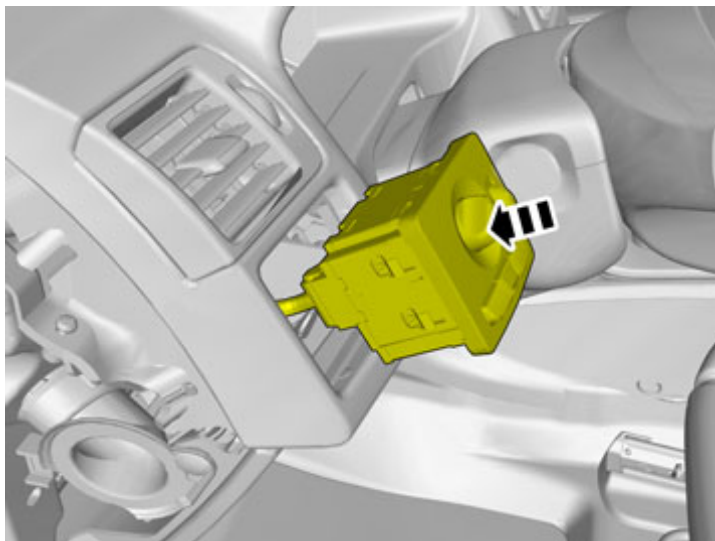

IMG-328428

9

Reinstall the removed parts in reverse order.

## Removal

# Installation instructions, accessories

Volvo Car Corporation Gothenburg, Sweden

10

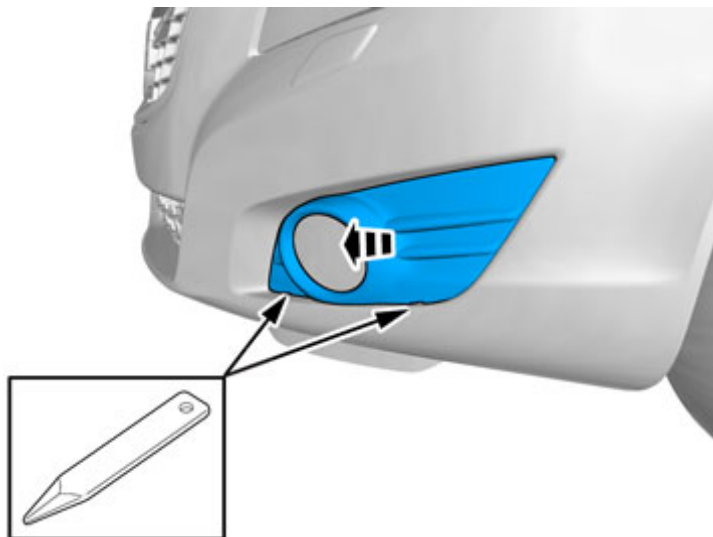

IMG-362020

Remove the panel.

11

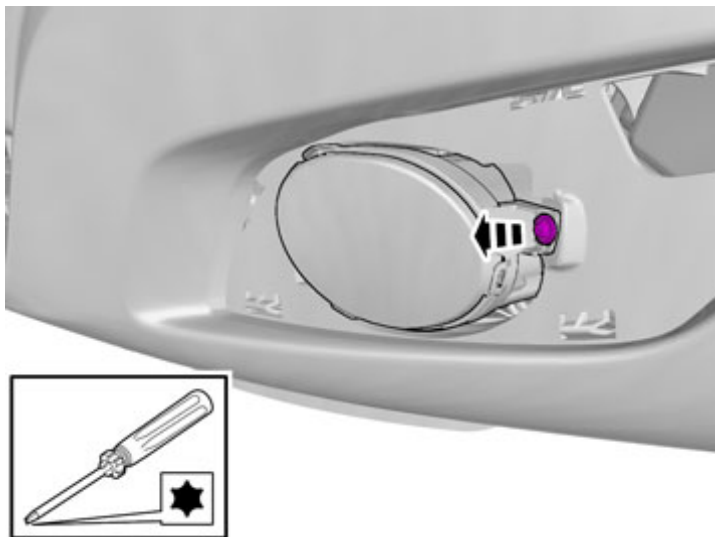

IMG-362021

Remove the screw.

Reuse existing parts.

# Installation instructions, accessories

Volvo Car Corporation Gothenburg, Sweden

12

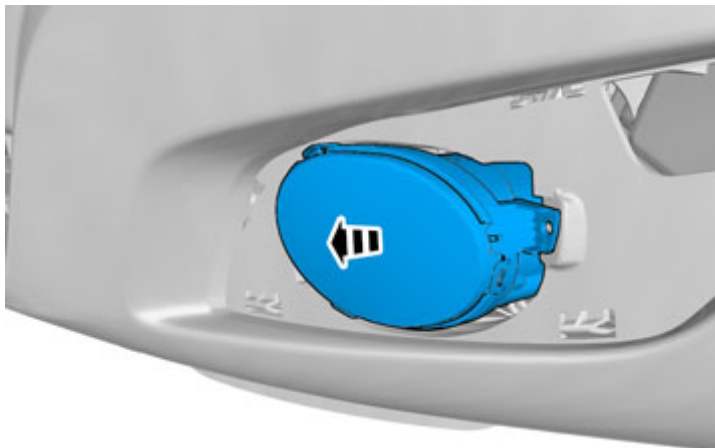

IMG-362026

13

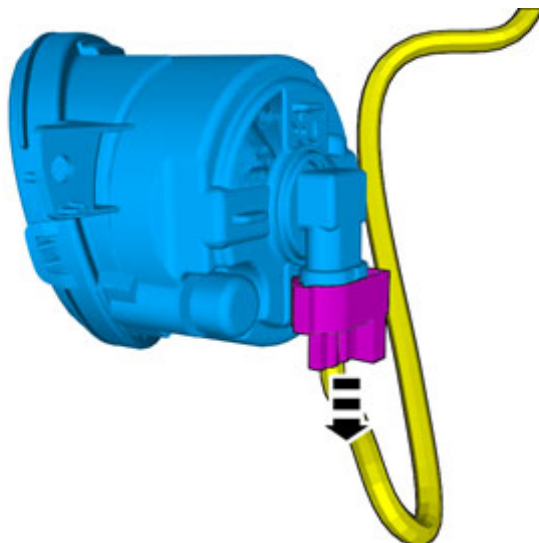

IMG-362027

Disconnect the connector.

**Accessory installation**

# Installation instructions, accessories

Volvo Car Corporation Gothenburg, Sweden

14

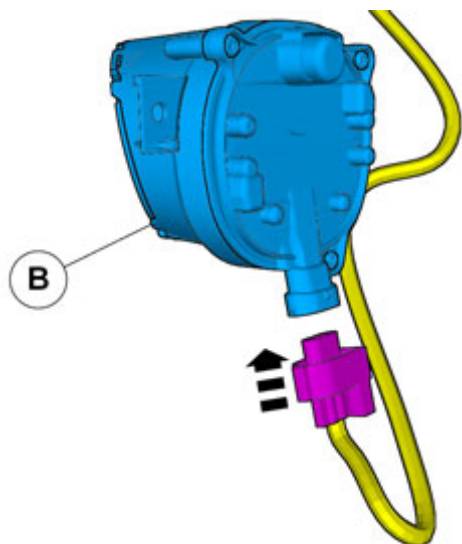

IMG-362046

15

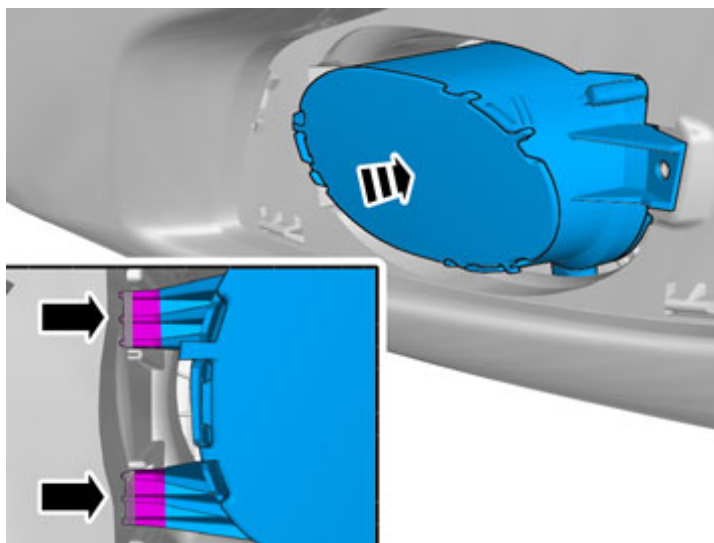

IMG-362068



# Installation instructions, accessories

Volvo Car Corporation Gothenburg, Sweden

16

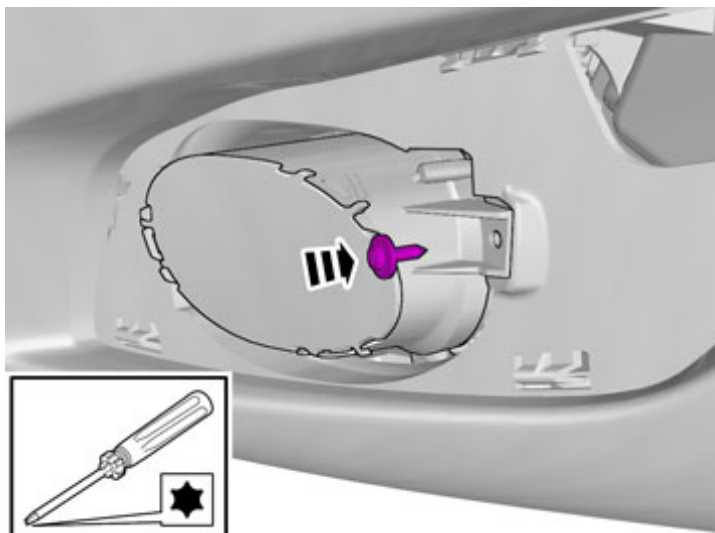

17

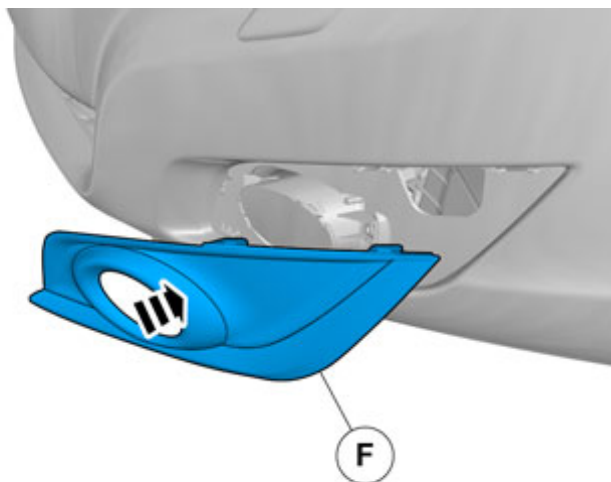

18

Repeat on the other side.

# Installation instructions, accessories

Volvo Car Corporation Gothenburg, Sweden

19

Download software (application) for the accessory's function according to the service information in VIDA. See VIDA or the accessories catalogue for software part number.

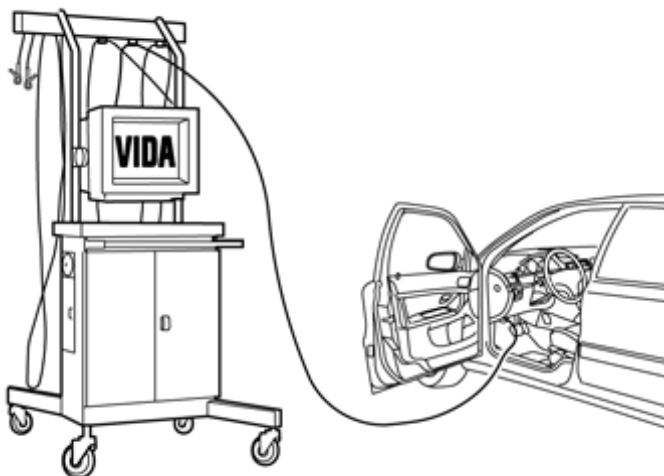

IMG-242268