

# Installation instructions, accessories

Volvo Car Corporation Gothenburg, Sweden

**Instruction No** 31373893  
**Version** 1.4  
**Part. No.** 30784190

## Sill decor

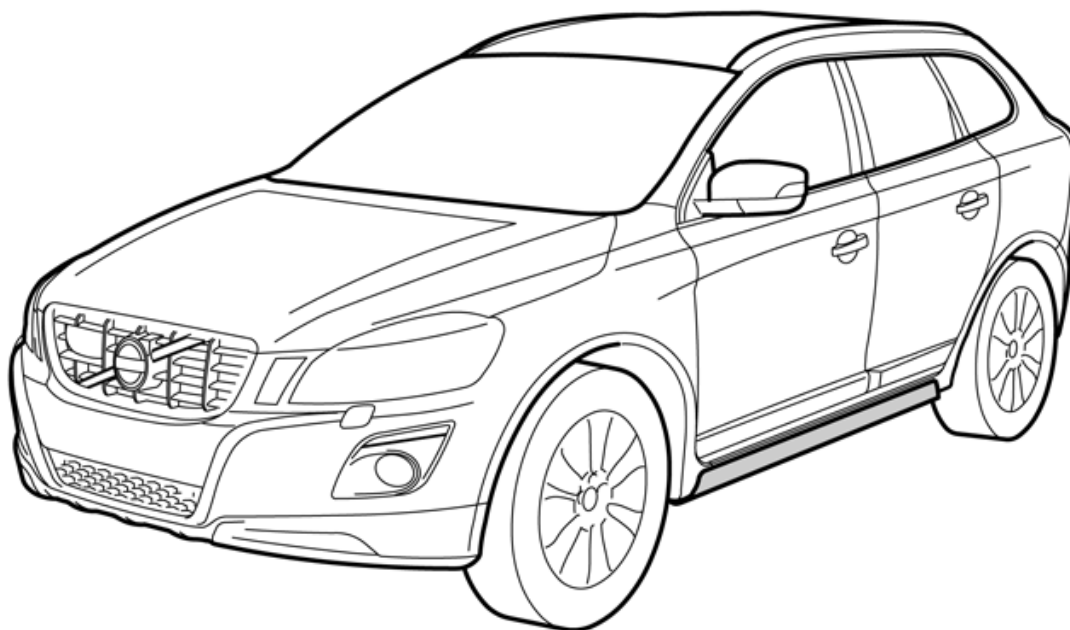

IMG-284607

### Equipment



A0000162



J0000368



IMG-239660



IMG-239681

2 h



A0000177

72h



IMG-251688

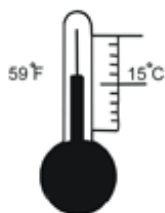

# Installation instructions, accessories

Volvo Car Corporation Gothenburg, Sweden

A0000170

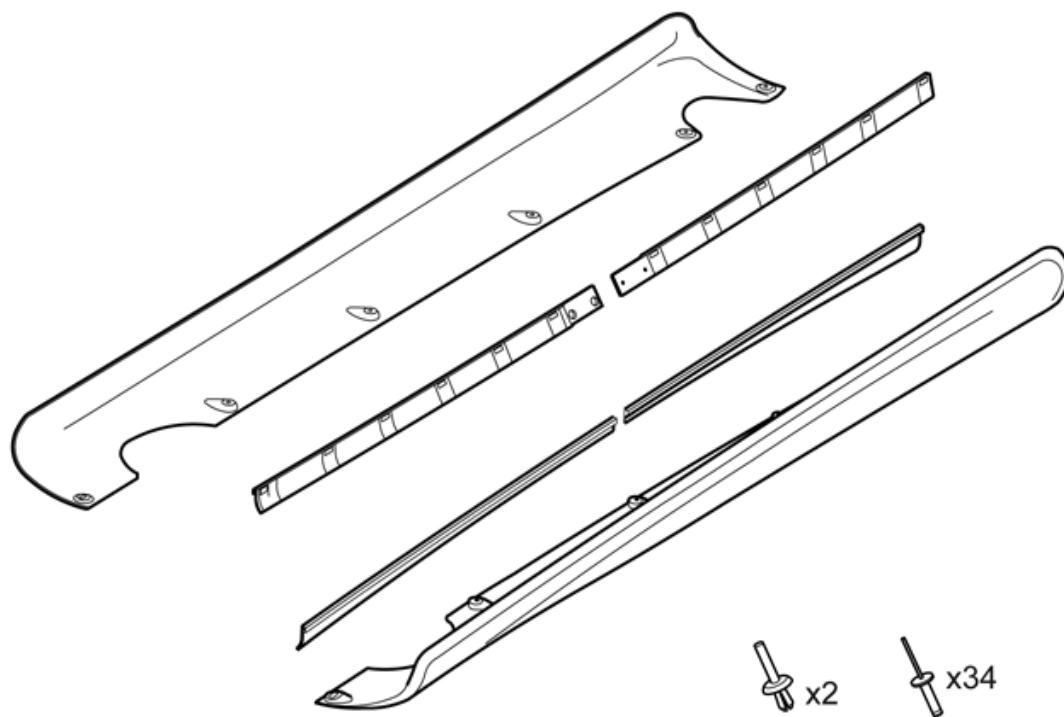

IMG-285341

# Installation instructions, accessories

Volvo Car Corporation Gothenburg, Sweden

Any comments on this publication?    Please contact your nearest retailer.    Thank You!

Publ.no:	Issue:	Kit no:
Comments:.....		
.....		
.....		
.....		

From:	
Address:	
Telephone:	
Telefax:	

IMG-213320

# Installation instructions, accessories

Volvo Car Corporation Gothenburg, Sweden

## INTRODUCTION

Read through all of the instructions before starting installation.

Notifications and warning texts are for your safety and to minimise the risk of something breaking during installation.

Ensure that all tools stated in the instructions are available before starting installation.

Certain steps in the instructions are only presented in the form of images. Explanatory text is also given for more complicated steps.

In the event of any problems with the instructions or the accessory, contact your local Volvo dealer.

1

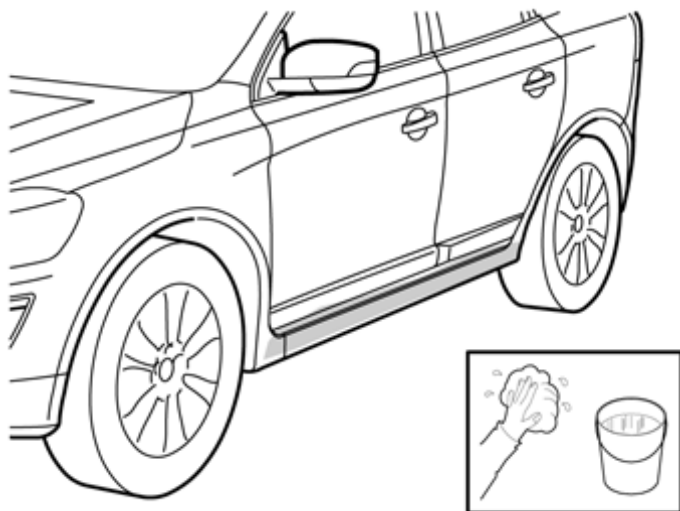

IMG-285323

2

## Installation of front cradle

Take one of the front cradles from the kit. All cradles are marked and only fit in one place. Always start with the front cradle.

Remove the protective tape from the mounting tape.

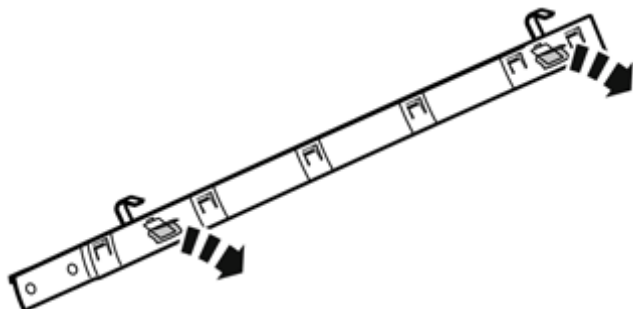

IMG-285327

# Installation instructions, accessories

Volvo Car Corporation Gothenburg, Sweden

3

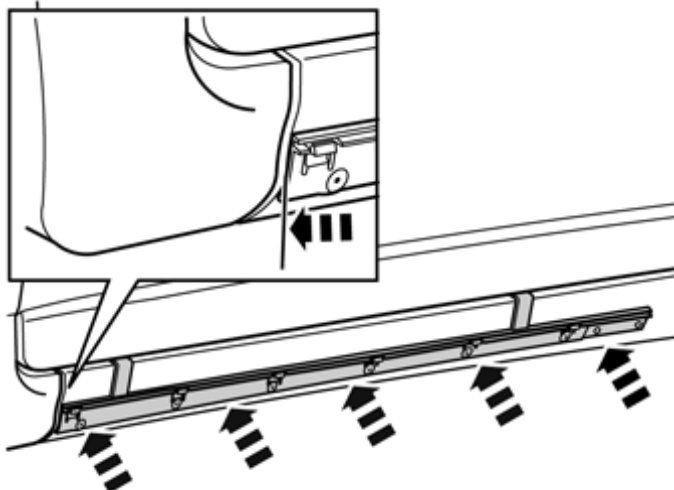

IMG-285328

Align the front edge of the cradle with the rear edge of the joint between the sill panels. Ensure that the tape does not adhere yet. At the same time hook the cradle on the top of the sill panel.

Press in the middle of the pieces of mounting tape.

4

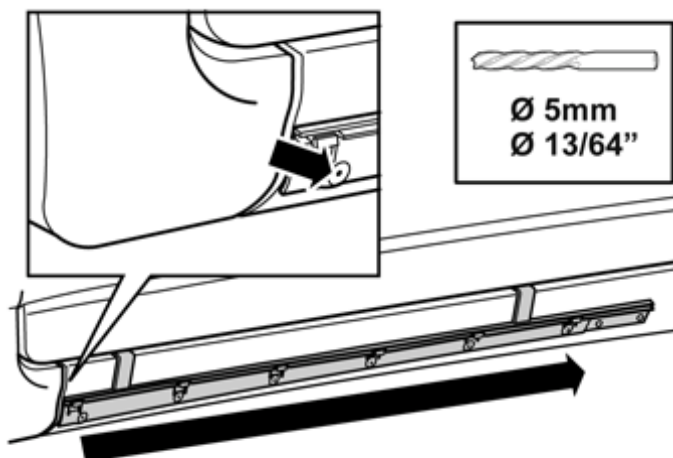

IMG-285329

Drill out the six marked holes in the cradle using a Ø 5 mm (13/64") drill bit.

Remove the swarf. Use a feeler gauge to remove swarf between the cradle and sill panel.

# Installation instructions, accessories

Volvo Car Corporation Gothenburg, Sweden

5

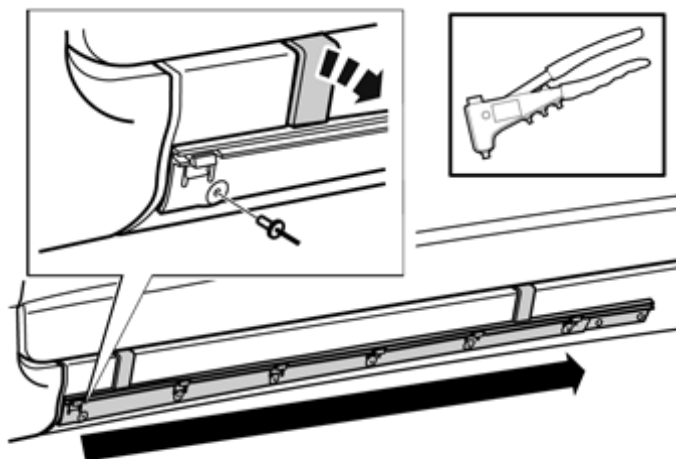

IMG-285330

Rivet the cradle in all holes at the sill panel.

Break off the hooks along the cradle.

6

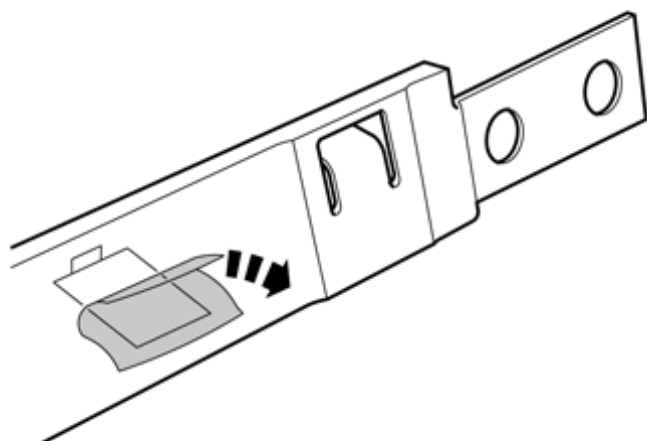

IMG-285331

## Installation of rear cradle

Take the rear cradle from the kit.

Remove the protective tape from the mounting tape at all locations.

# Installation instructions, accessories

Volvo Car Corporation Gothenburg, Sweden

7

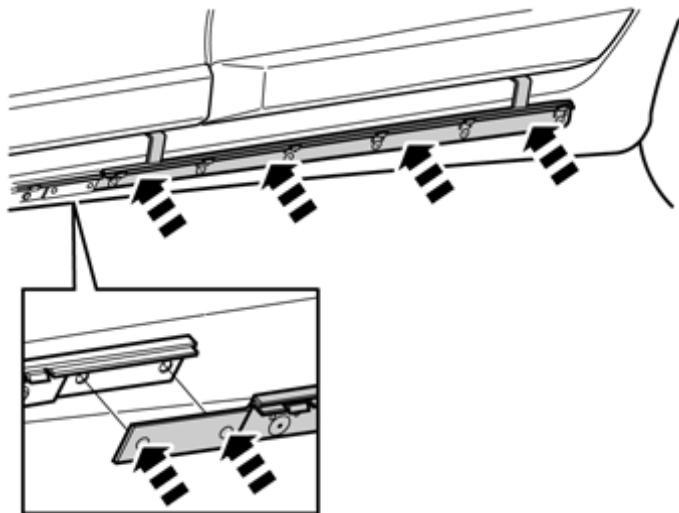

IMG-285332

Align the lugs on the cradle with corresponding holes in the front cradle. Ensure that the tape does not adhere yet.

Hook into the sill panel's upper edge and press at the pieces of mounting tape.

8

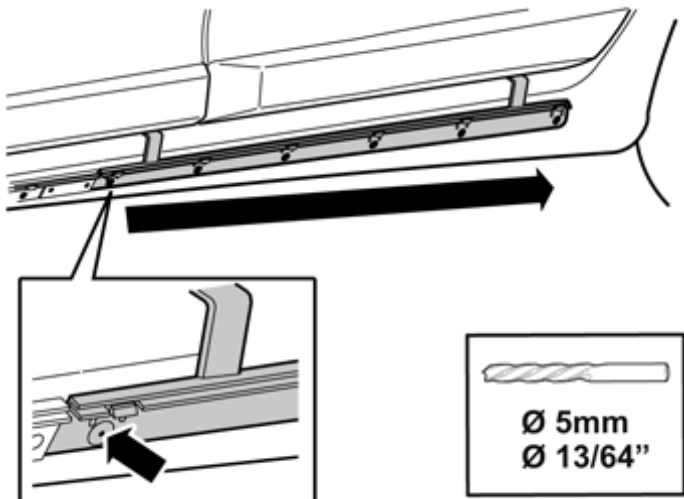

IMG-285333

Drill out the six marked holes using a Ø 5 mm (13/64") drill bit.

Remove the swarf. Use a feeler gauge to remove swarf between the cradle and sill panel.

# Installation instructions, accessories

Volvo Car Corporation Gothenburg, Sweden

9

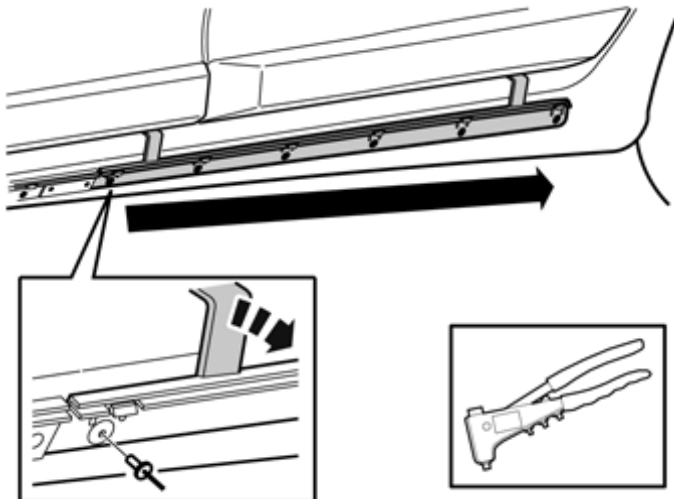

IMG-285334

Rivet the cradle in all holes at the sill panel.

Break off the hooks along the cradle.

10

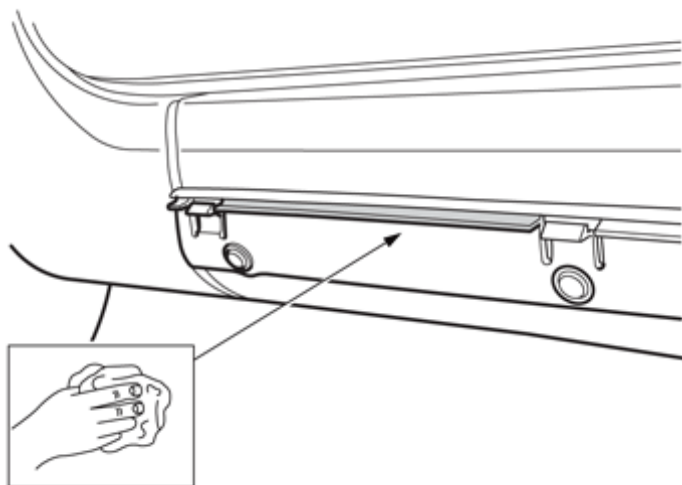

IMG-302003

## Note!

Points 10-12, which describe bonding of the sill decor, are carried out to prevent the sill decor from detaching if the lifting table lifting plates are incorrectly positioned against the door sill panel and not against the intended lifting points at the front and rear edges of the door sill. Workshop lifts that lift all away along the door sill must be used with care.

Clean the marked area in the groove between the mounting hooks on the cradle using isopropanol and wipe dry.

Repeat the procedure with the rear cradle's rear end.



# Installation instructions, accessories

Volvo Car Corporation Gothenburg, Sweden

11

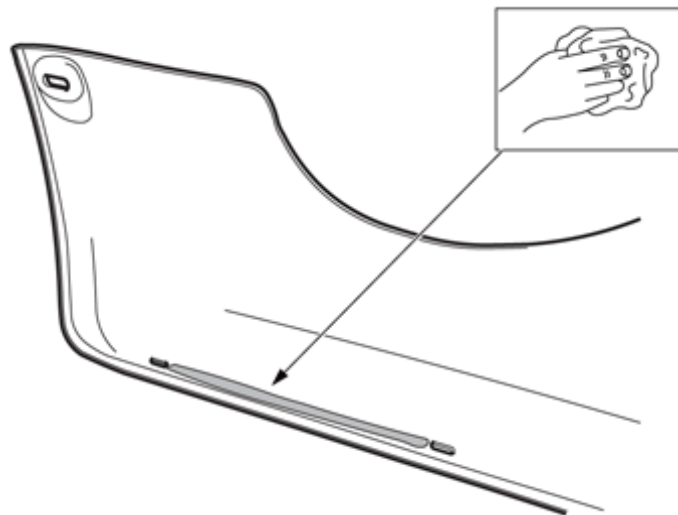

IMG-302004

Clean the marked area on the protrusion between both mounting hooks on the front edge of the decor strip using isopropanol and wipe dry.

Repeat the procedure with the rear end.

12

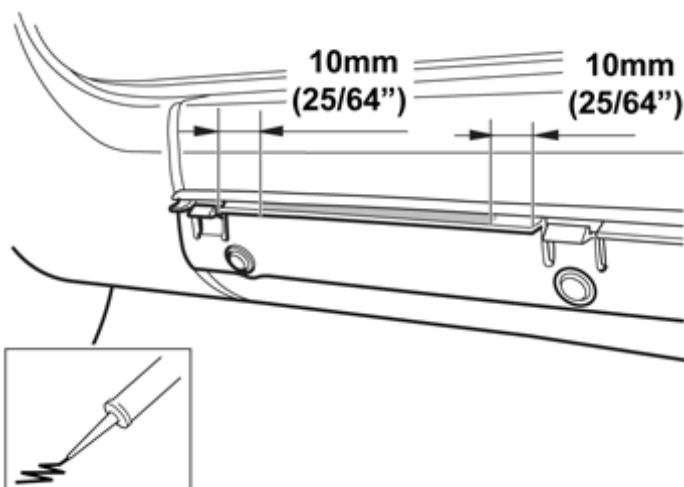

IMG-302005

## Note!

Work must not be carried out at temperatures above 15° C (59° F). Use the nozzle found on the adhesive tube. The bead must not be thicker than the smallest hole in the nozzle.

Apply a single component adhesive to the groove between both mounting hooks on the front cradle, 10 mm (25/64") from the ends of the mounting hooks.

Repeat the procedure with the rear cradle's rear end.

# Installation instructions, accessories

Volvo Car Corporation Gothenburg, Sweden

13

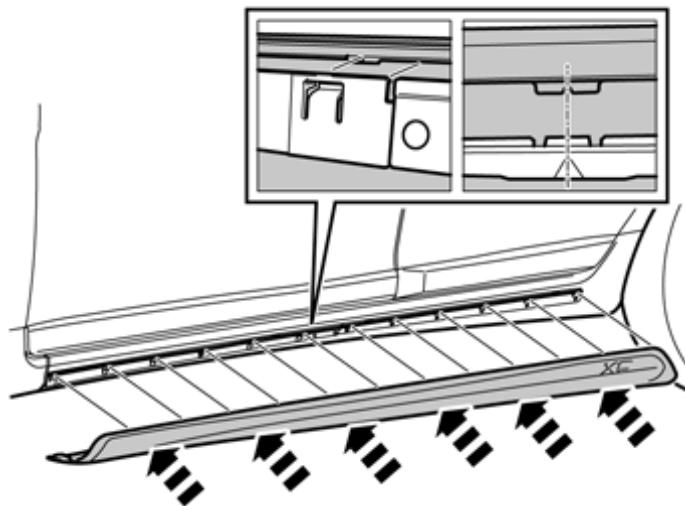

IMG-285335

## Note!

Two people are required for this step.

Align the decor strip's notch, placed on one of the middle catches, in front of the arrow tip at the front end of the rear cradle. The catches and edge must align with the corresponding cradle.

Press the decor panel into the cradles. A clicking noise should be heard when the decor strip is pressed, except from the surfaces where the adhesive is applied.

Ensure that the entire decor strip clicks into place properly.

14

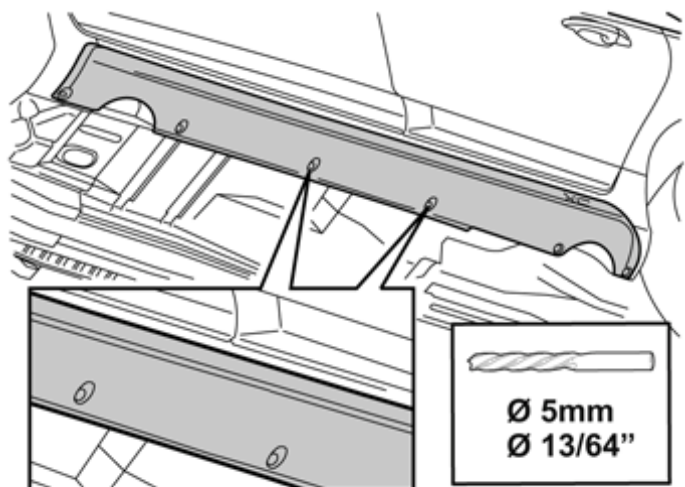

IMG-285336

Press the lower part of the panel towards the sill panel at the middle holes and drill through both using a Ø 5 mm (13/64") drill bit.

Remove any swarf.

# Installation instructions, accessories

Volvo Car Corporation Gothenburg, Sweden

15

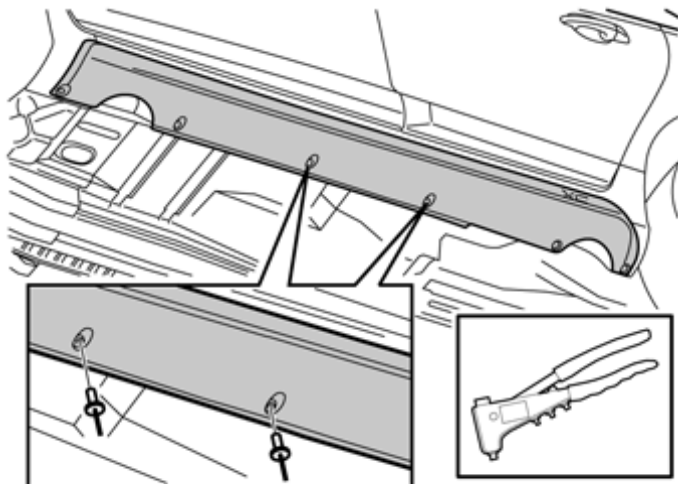

IMG-285337

Rivet the panel through the two holes.

Repeat drilling and riveting for the two rear holes.

16

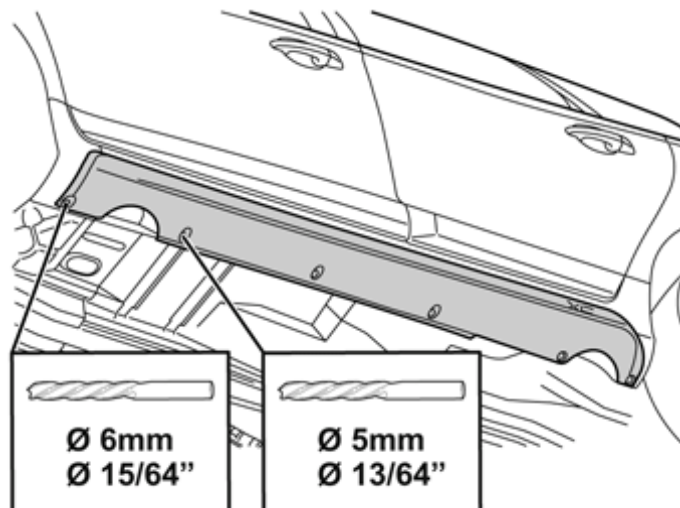

IMG-285338

Press the lower part of the panel towards the sill panel at the front holes.

Drill out the rear hole using a Ø 5 mm (13/64") drill bit and the front using a Ø 6 mm (15/64") drill bit.

## Note!

Drill through the middle of the oval hole.

Remove any swarf.

# Installation instructions, accessories

Volvo Car Corporation Gothenburg, Sweden

17A

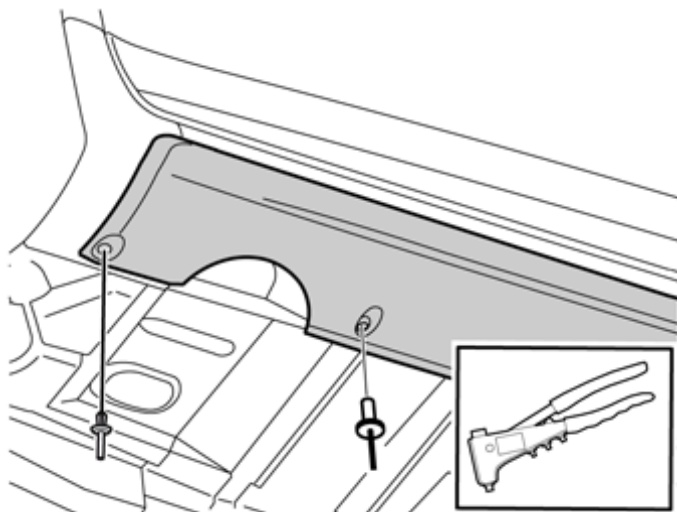

IMG-285339

17B



IMG-293863

## Illustrations A and B

### Note!

First detach the central pin from the clip by tapping it in and then pulling it out, but leave it inside the clip a few millimeters. This is done because the decor panel springs in when the clip is attached and the central pin can break off when tapped in.

Attach the panel in the rear hole using a pop rivet and in the front using a clip with central pin.

Repeat the operation on the other side.

18

### Note!

The vehicle must not be used within two hours of carrying out the work.

### Note!

Do not wash the vehicle within 72 hours of carrying out the work.