

ACCESSORIES USER GUIDE

Specifikationer, konstruktionsdata och illustrationer i denna publikation är inte bindande. Vi förbehåller oss rätten att göra ändringar utan föregående meddelande.

The specifications, constructional data and illustrations contained in this publication are not binding. We reserve us the right to make alterations without prior notification.

Les spécifications, les données de construction et les illustrations de cette publication ne sont contractuelles. Nous nous réservons le droit d'effectuer des modifications sans notification préalable.

Die in dieser Veröffentlichung enthaltenen technischen Daten, Konstruktionsdaten und Abbildungen sind nicht bindend. Wir behalten uns das Recht vor, Änderungen ohne vorherige Ankündigung vorzunehmen.

Tässä julkaisussa olevat erittelyt, rakennetiedot ja kuvat eivät ole sitovia. Pidätämme itsellämme oikeuden tehdä muutoksia niistä ennalta ilmoittamatta.

Le specifiche, i dati di costruzione e le illustrazioni contenute nella presente pubblicazione non sono vincolanti. Ci riserviamo il diritto di apportare modifiche senza preavviso.

Las especificaciones, datos de construcción e ilustraciones de esta publicación no son vinculantes. Nos reservamos el derecho de realizar alteraciones sin notificación previa.

De specificaties, constructiegegevens en afbeeldingen in deze uitgave zijn niet bindend. We behouden ons het recht voor om wijzigingen aan te brengen zonder voorafgaande kennisgeving.

Las especificações, dados de construção e figuras desta publicação não são vinculativas. Reservamo-nos o direito de fazer alterações sem notificação prévia.

Bu yayında bulunan teknik özellikler, yapısal veriler ve çizimler bağlayıcı değildir. Önceden bildirmeksizin bu bilgilerde değişiklik yapma hakkımızı saklı tutarız.

Спецификации, конструкторские данные и иллюстрации в данной публикации могут быть изменены. Мы оставляем за собой право на внесение изменений без предварительного предупреждения.

当ガイド内の仕様、デザインデータ、及びイラストには拘束力がありません。当社は予告無しに内容を変更する権利を有します。

本出版物内の規格、構造データ与插图不受限制。我们保留进行更改而无须事先通知之权力。

EN - Charging station	3
ZH - 充电站	19





EN - Charging station

Customer support	4
Introduction	5
Use	8
Troubleshooting	11
Appendix	14



Customer support

Owner's information

Model: EVSE-VX

Serial number:

Date of purchase:

Write down the serial number of your charging station.

The serial number can be found on the side of the charging module, see illustration.

To ensure correct servicing, please state your serial number when contacting your local Volvo dealer.



Regulatory authorities

Region	Authority
China	GB/T

Regulatory authorities set standards and regulations for products used in each geographical area.

About the charging station

The charging station charges your electric vehicle, and is compatible with different electric and plug-in hybrid vehicles.

To avoid unauthorised use, we recommend installing a circuit breaker inside your property.

The charging station comes with a 2 year warranty, from the date of delivery, which covers original faults. External damage is not covered by the warranty.

In the event of a technical fault with the charging station, see the troubleshooting guide further on in this manual. If the fault cannot be rectified using this guide, please contact your local Volvo dealer for further troubleshooting.

The charging station is powered by a 220 V, 50 Hz alternating current source.

Key features:

- Integrated cable hanger
- Overheat protection
- Quick-read status indicators
- Approved by Underwriters Laboratories (UL), CE and CQC
- GB/T compatible

Operation:

The charging station is connected to 220 V alternating voltage.

Maximum consumption for China (GB/T) is 16 A. The circuit breaker must be dimensioned for 20 A.

Caution!

The charging station must be installed by an authorised electrician. To prevent serious injury or death, the installation must follow the regulatory authorities' regulations and local regulations for electrical installations.

Caution!

The charging station must be grounded. The charging station detects if there is no grounding and then stops working.

Caution!

Incorrect connection of the electrical ground strip can cause risk of electric shock. Do not modify the connector supplied with the charging station if it does not fit the socket. Engage an authorised electrician to install the correct socket.

Caution!

Do not drop the charging station or the charging handle.

Introduction

Warning!

If the charging cable is separated from the charging station or charging handle, do not attempt to repair it yourself. Contact your local Volvo dealer for assistance.

Caution!

If the charging station becomes damaged in any way, stop using it immediately and contact your local Volvo dealer for assistance.

Caution!

Always follow basic precautions when using the charging station.

Caution!

Read all instructions in this manual and all warning information before using the unit for the first time.

Caution!

Children should be supervised when in the vicinity of the charging station, when the charging station is connected.

Caution!

Never insert your fingers into the socket on the charging handle.

Caution!

To reduce the risk of fire, only connect to a power supply fused with maximum 20 A (GB/T).

Caution!

Do not use the charging station where there may be fumes from flammable fuels.

Caution!

The charging station detects whether there is a correct ground connection, and does not work if the ground connection is disconnected.

Components

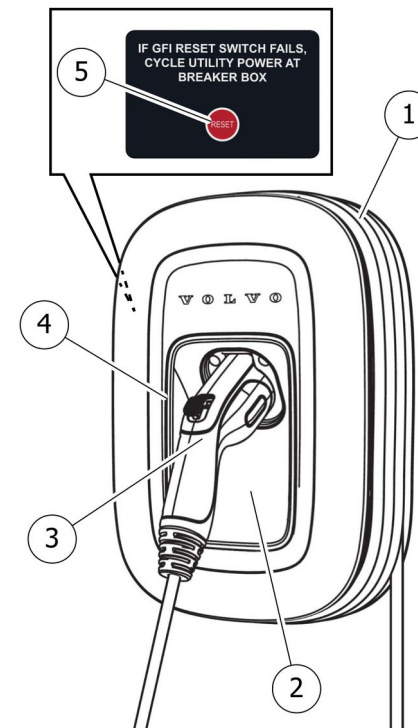

- 1 Integrated cable hanger
- 2 LED lamp
- 3 Charging handle
- 4 Light ring
- 5 Reset button

The charging station has an integrated cable hanger. The charger casing's shape makes it possible to wrap the cable around the unit, preventing it from lying on the ground during storage.

The docking port in the middle of the charging module holds the charging handle in place when not in use.

Always connect the charging handle to the docking port when the charger is connected to the vehicle.

The charging station has a reset button located under the decal on the side of the charger casing.

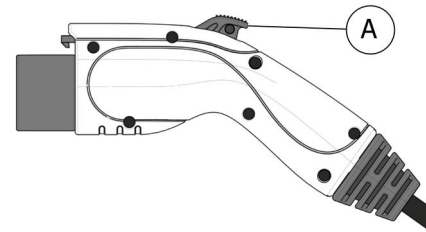

The charging handle for China (GB/T) has a button (A) to detach the handle from the vehicle.

Requirements for installation

Note!

All electrical installations must be performed and checked by an authorised electrician.

Note!

The charging station's connection requirement is 220 V alternating voltage. The circuit breaker must be dimensioned for 20 A (GB/T).

Use

Indicator lamps

The charging station has an LED lamp that lights up on the underneath of the charging handle, as well as a light ring indicator, which surrounds the docking port for the charging handle.

The indicator lamps work as follows:

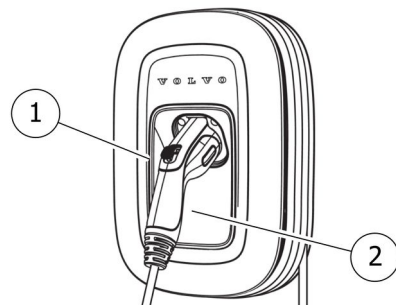
**Light ring**

The light ring (1) can light in two colours.

When the charger is connected to a vehicle, the light ring lights with a white light to indicate charging status.

A red light indicates that a fault has occurred. The charger will then not supply the vehicle with any voltage. The fault must be rectified before charging can be started or continue. For more information,

see the troubleshooting guide in the section: Troubleshooting.

LED lamp

When the charger is not connected to a vehicle, the LED lamp (2) lights under the charging handle with a white light to indicate that the charger is ready for use.

Note!

The light ring flashes red at the first start-up, and works as a safety check during start-up. The flashing is followed by a constant light from the white LED lamp.

Caution!

A constant light or flashing red light from the light ring indicates an actual problem.

Charging the vehicle

- Ensure that the car is in **P** and switched off.
- Check that the charging station is on. If not, turn on the current.
- Connect the charging handle to the car's charging socket until it clicks. When the charging handle is locked in, it will not loosen until the button for loosening from the vehicle has been depressed.

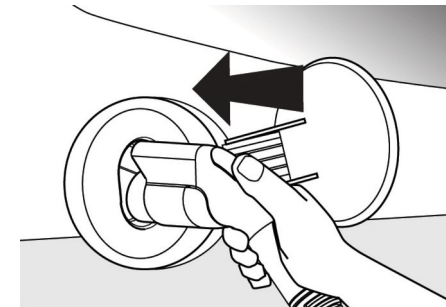

Charging starts automatically.

When charging starts, the light ring flashes briefly with a red light.

The charging output is adjusted according to the vehicle's needs.

If the vehicle is being charged, the light ring pulses at approximately two-second intervals.

- Always check that the charging station indicates that the vehicle is being charged.

When the vehicle is fully charged, the white status-indicator lights white continuously.

Your vehicle has an indicator on the instrument panel that can verify whether the vehicle is fully charged. See the owner's manual for the vehicle for the location of the indicator on the instrument panel.

- Disconnect the charger when charging is complete. Press the release button on the charging handle, and remove it from the vehicle.
- Ensure that any snow is removed from the docking port before replacing the charging handle.

Note!

The light ring lights in red if the vehicle is not being charged. The charging station is switched off if the circuit breaker or ground fault breaker is triggered.

Note!

If charging with the charging station does not work, try charging with the charging cable supplied with the vehicle.

Note!

The charging capacity is dependent on the ambient temperature.

Manual disconnection

See the owner's manual for the vehicle for how to stop charging.

Then remove the charging handle from the vehicle. Depress the release button on the charging handle, and remove the handle from the vehicle.

The white LED lamp lights to indicate that the charging handle has been removed from the vehicle.

Use

Manual restart

The charging station has a reset button for the ground fault breaker. The button allows charging to be reset, without using the circuit breaker.

If the system is not reset via the reset button, switch off the voltage to the charging station, wait 1 minute and switch on the voltage again.

If the fault persists, do not make any more attempts to charge your vehicle. Contact your local Volvo dealer for assistance.

Troubleshooting

Troubleshooting

Use this troubleshooting guide to find solutions to common faults.

The troubleshooting guide can also be useful if problems occur during charging with the charger that comes with the vehicle.

i Note!

Do not try to repair or service the charging station yourself. There are no serviceable components the user can service.

Fault indication via the light ring can be triggered by several sources, including the charger, the vehicle, or service on the mains power supply. See troubleshooting tips further on.

The light ring is switched on when the charger detects a fault, regardless of whether it is connected to your vehicle or not.

The charger will not measure any current to the vehicle as long as the light ring lights in red.

The fault must be rectified before charging can be started or resumed.

Problem

The white LED lamp by the charging handle does not light

Possible cause	Solution
No current supply to the unit	Check the circuit breaker and fuse in the central electrical unit.
Internal charger fault	Contact your local Volvo dealer for assistance.

Problem

Vehicle not charging. The light ring continues to light in red.

Possible cause	Solution
The charging handle is not correctly connected to the vehicle.	Check the charging handle. Remove the charging handle from the vehicle; reconnect the handle in the vehicle's charging socket until it clicks.
Vehicle state does not permit charging	Check the vehicle's charging settings (if the vehicle allows setting of charging time). Refer to the owner's manual for the vehicle for instructions.
Communication fault between charger and vehicle	Contact your local Volvo dealer for assistance.

Troubleshooting

Problem

The light ring flashes rapidly with a red light

Possible cause	Solution
----------------	----------

- | | |
|-------------------|---|
| Mains power fault | <ul style="list-style-type: none"> – Reset the charger via the circuit breaker in the central electrical cabinet. – If the problem persists, request a qualified electrician to inspect the wall socket's ground circuit. |
|-------------------|---|

Problem

The light ring flashes rapidly with a red light

Possible cause	Solution
----------------	----------

- | | |
|--|--|
| The charging station's temperature is too high. The charger will restart charging when it has cooled down. | <ul style="list-style-type: none"> – Check if the charging station is overheated (hot to touch). Pull out the charging handle and allow it to cool down. If the problem persists, contact your local Volvo dealer. – Switch off the current to the charging station. – Ask an electrician to inspect the installation. Perform any repairs necessary. |
|--|--|

Problem

The light ring lights with a constant red light when the charger is connected to the vehicle
The light ring is switched off and the LED lamp lights when the charger has been disconnected from the vehicle

Possible cause	Solution
----------------	----------

- | | |
|--------------------------|---|
| Problem with the vehicle | Contact your local Volvo dealer for assistance. |
|--------------------------|---|

Troubleshooting

Problem

The light ring lights with a constant red light when the charger is NOT connected to the vehicle

Possible cause	Solution
----------------	----------

Internal charger fault	Contact your local Volvo dealer for assistance.
------------------------	---

Problem

The light ring flashes alternately between red and white.

Possible cause	Solution
----------------	----------

The charger attempts to solve an internal fault	The charger resumes normal operation within one minute. If the problem persists, contact your local Volvo dealer for assistance.
---	--

Appendix

Main specifications

Model	EVSE-VX
Supply voltage:	220 V, alternating current
Charging current:	16 A at 220 V, alternating current (GB/T)
Requirements, circuit breaker	20 A at 220 V, alternating current (GB/T)
Frequency:	50 Hz
Cables, mains power supply	Cable area according to local regulations
Energy consumption at idle:	< 2 W
Energy consumption during charging:	< 4 W
Cable length:	Approx. 7 m (23 ft.)
Weight:	5.8 kg (12.75 lb.)
Temperature during operation:	-40°C to +55°C (-40°F to +131°F)
Temperature during storage and transport:	-40°C to +80°C (-40°F to +176°F)

Environmental marking:	IP66 (waterproof)
Protocol, communication vehicle-charger:	GB/T 18487
Charging direction:	Mains to vehicle

Specifications are subject to change without notice.

High voltage warnings

 **Warning!**

High voltage is present in electricity meters and central electrical cabinets. Contact with high voltage can cause death or serious injury.

 **Caution!**

Do NOT use the charging station if the charging cable, charging handle or charging station are damaged. Inspect all parts before use. In the event of damage, stop using the charging station and contact your local Volvo dealer.

 **Caution!**

ALWAYS place the charging cable out of the way so that it is not a tripping hazard, is at risk of being run over, stepped on or damaged or put under strain in any other way. To prevent personal injury and damage to the charging station, ALWAYS store the charging cable on the hanger when it is not connected to a vehicle.

Caution!

Only use the charging station to charge electric vehicles equipped with an SAE J1772 Type 1 compatible socket. For more information, see the vehicle's owner manual.

Note!

Disconnect the current from the charging station before cleaning. To clean the charging station, wipe with a cloth, dampened with water or a mild cleaning solution suitable for use on car paintwork. Do not use chemicals or solvents. Do not submerge the charger in liquid.

Proposition 65 warnings (California)

Caution!

This product contains a chemical that, to the knowledge of the state of California, may cause cancer, birth defects or other reproductive harm.

FCC information

This product complies with Part 15 of the FCC regulations. Use is subject to the following two conditions:

- The product may not cause harmful interference.
- The product must accept all incoming interference, including interference that can cause unwanted operation.

This product has been designed to protect against radio interference. However, there are cases where strong radio signals or nearby equipment (digital phones, radio communication equipment, etc.) can affect operation.

If you suspect that the charger is affected by incoming radio signals, carry out the following steps before contacting customer support for service:

- Move nearby electrical devices or electrical equipment away during charging.
- Switch off electrical devices or electrical equipment during charging.

Note!

Changes or modifications to the charging station, by someone other than an authorised electrician, revokes the FCC compliance.

Appendix

Symbol explanation

 Warning!

- Warning texts inform of risk of personal injury.

 Caution!

- Important-texts inform of risk of material damage.

 Note!

- Note-texts give advice or tips that facilitate installation or use.

Safety functions

The charging station is designed with the user's safety as highest priority, and consists of the following safety features to protect against electric shocks:

– **Checking protective ground:**

The charging station is continually checked for ground connection. If the protective ground is broken, the charger's light ring lights in red and the charging current to the vehicle is interrupted.

– **Thermal event sensor:**

The charging station detects deviating thermal events and switches off as necessary.

– **Protection in the event of grounding fault:**

The charging station is equipped with a ground fault breaker to protect against electric shock. If a ground fault is detected, the power supply to the charging cable is switched off, and the light ring indicates a fault.

– **Isolation:**

The charging module, adapter, wiring and charging handle are completely isolated (no exposed conducting parts) to protect against electric shock.

– **Unintentional disconnection:**

The charging handle is designed to minimise the risk of unintentional disconnection. A signal conductor in the charging cable and the charging handle eliminate the risk of electric shock when the charging handle is not connected to a vehicle, or if unintentionally disconnected during charging.

Disconnection during charging occurs without safety risk.

List of abbreviations

A	Amperes
AWG	American wire gauge
CE	Conformité Européene (European Conformity)
CQC	China Compulsory Certification
FCC	Federal Communications Commission
GB/T	Guobiao/T Recommended standards of the Chinese National Committee of the ISO and IEC.
Hz	Hertz
IEC	IEC International Electrotechnical Commission
LED	Light Emitting Diode
UL	Underwriters' Laboratories
V	Volts
W	Watt



ZH - 充电站

客户支持	20
简介	21
使用	24
故障排除	26
附录	29

客户支持

车主信息

型号：EVSE-VX

序列号：

购买日期：

记下您的充电站序列号。

序列号可在充电模块侧面找到，见插图。

要确保正确维修保养，请在联系当地沃尔沃经销商时说明您的序列号。



监管机构

地区	主管机构
中国	GB/T

监管机构为每个地理区域使用的产品都制定了标准和法规。

关于充电站

充电站用于为您的电动车充电，能够与不同的电动及插电式混合动力车型兼容。

要避免未经授权使用，我们建议在您的住宅中安装断路器。

充电站从交付之日起保修2年，包括原发性故障。外部损坏不在保修范围内。

如果充电站出现技术故障，请参见本手册中的故障排除指南。如果使用本指南无法修正故障，请联系您当地的沃尔沃经销商执行进一步的故障排除。

充电站由220 V，50 Hz交流电源供电。

主要特点：

- 集成电缆吊架
- 过热保护
- 快速读取状态指示灯
- 经由美国安全试验所 (UL)、CE和CQC 批准
- GB/T 兼容

操作：

充电站连接至220 V交流电。

中国 (GB/T) 的最大电流消耗为16 A。断路器的规格必须适用于20 A。

小心！
充电站必须由获得授权的电工执行安装。为防止严重伤亡事故，安装必须遵守监管机构和当地实施的有关电气安装的法规。

小心！
充电站必须接地。如果充电站检测到未接地，则停止工作。

小心！
电气接地片连接错误可能会导致触电危险。如果充电站附带的连接器不适用于插座，不得对其进行改装。请授权电工安装正确的插座。

小心！
充电站或充电手柄不得掉落。

警告！
如果充电电缆与充电站或充电手柄分离，不得尝试自行修理。请联系当地的沃尔沃经销商寻求帮助。

简介

⚠ 小心！

如果充电站受到任何损坏，请立即停止使用，并联系当地的沃尔沃经销商寻求帮助。

⚠ 小心！

使用充电站时，务必遵循基本注意事项。

⚠ 小心！

初次使用本装置之前，请阅读本手册中的所有说明和所有警告信息。

⚠ 小心！

连接充电站时，应妥善看管充电站附近的儿童。

⚠ 小心！

切勿将手指插入充电手柄上的插座。

⚠ 小心！

只能连接至保险丝最大规格为 20 A (GB/T) 的电源，以减少火灾风险。

⚠ 小心！

不要在易燃燃料可能产生烟气的情况下使用充电站。

⚠ 小心！

充电站可检测接地连接是否正确，如果接地连接断开，则充电站不工作。

组件

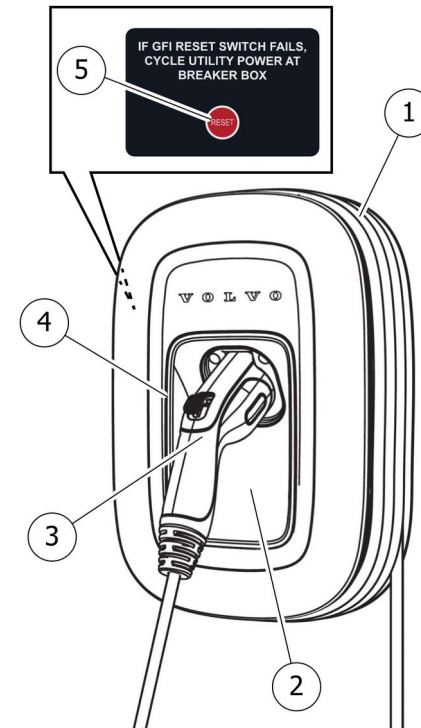

- 1 集成电缆吊架
- 2 LED指示灯
- 3 充电手柄
- 4 光环
- 5 重置按钮

充电站具有集成电缆吊架。充电器外壳的形状允许将电缆缠绕在该装置周围，防止其在存放期间倒在地面上。

充电模块中间的对接端口在充电手柄不使用时将其固定到位。

充电器连接至车辆时，务必将充电手柄连接至对接端口。

充电站在充电器外壳侧面的标示牌下方设有一个重置按钮。

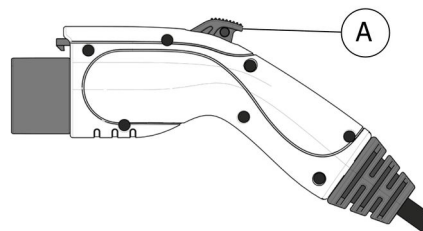

向中国 (GB/T) 市场提供的充电手柄设有一个用于将手柄从车辆分离的按钮 (A)。

安装要求

注意！

所有的电气装置必须由获得授权的电工执行安装和检查。

注意！

充电站的连接要求为220 V交流电压。断路器的规格必须适用于20 A (GB/T)。

使用

指示灯

充电站有一个LED指示灯，在充电手柄下方亮起，还有一个光环指示灯，位于充电手柄的对接端口周围。

指示灯工作如下：

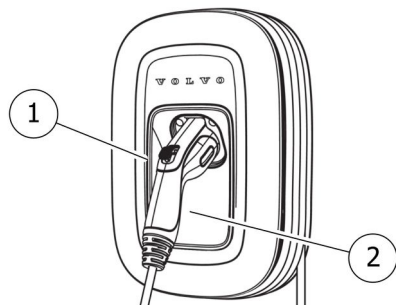

光环

光环 (1) 可以呈两种颜色亮起。

当充电器连接至车辆时，光环呈白色亮起，指示充电状态。

呈红色亮起指示发生故障。于是充电器将不向车辆提供任何电压的电力。必须在修正故障后才能开始或继续充电。有关更多信息，请参看“故障排除”章节的故障排除指南。

LED指示灯

当充电器未连接至车辆时，充电手柄下面的LED指示灯 (2) 呈白色亮起，指示充电器已准备就绪。

注意！

光环在首次启动时呈红色闪烁，并在启动期间用于执行安全检查。白色LED指示灯在光环结束闪烁后保持常亮。

小心！

光环常亮或呈红色闪烁指示发生实际问题。

车辆充电

- 确保车辆挂入P档且点火开关关闭。
- 检查确认充电站开启。如果未开启，则接通电流。
- 将充电手柄连接至车辆的充电插座，直到听到咔哒声。充电手柄在锁定入位后不会自行松动，直至按下用于将其从车辆分离的按钮。

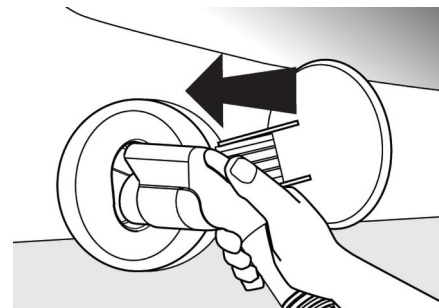

充电自动开始。

开始充电时，光环呈红色短闪。

充电输出根据车辆需求进行调整。

如果车辆正在充电，光环以两秒为间隔闪烁。

- 务必检查充电站是否指示车辆正在充电。

当车辆充满电时，白色状态指示灯会持续亮起。

您的车辆仪表板上有一个指示灯，可用于确认车辆是否充满电。请参见车主手册，了解仪表板上指示灯的位置。

- 充电完成后断开充电器。按下充电手柄上的释放按钮，然后将其从车辆上拔下。
- 更换充电手柄之前，请确保清除对接端口上的积雪。

i 注意！

如果车辆未处于充电状态，光环呈红色亮起。如果断路器或接地故障断路器脱扣，充电站关闭。

i 注意！

如果充电站无法充电，请尝试使用车辆随附的充电电缆进行充电。

i 注意！

充电容量取决于环境温度。

手动断开连接

请参看相应车辆的车主手册，了解如何停止充电。

然后从车辆拔下充电手柄。按下充电手柄上的释放按钮，然后将手柄从车辆上拔下。

白色LED指示灯亮起，指示充电手柄已从车辆上拔下。

手动重启

充电站设有一个用于接地故障断路器的重置按钮。通过此按钮无需使用断路器即可重置充电。

如果无法通过重置按钮重置系统，切断充电站电源，然后在等待1分钟后重新接通电源。

如果故障依然存在，不得再次尝试给您的车辆充电。请联系当地的沃尔沃经销商寻求帮助。

故障排除

故障排除

使用此故障排除指南查找常见故障的解决方案。

如果在使用车辆附带的充电器进行充电期间出现问题，故障排除指南也会非常有用。

 注意！

不得尝试自行修理或维修充电站。不存在用户可以维修的可维修组件。

可能有多种来源触发光环指示故障，包括充电器、车辆或主电源维修。进一步参见故障排除技巧。

当充电器检测到故障时，光环亮起，无论充电器是否连接至您的车辆。

只要光环呈红色亮起，充电器就不会检测供至车辆的任何电流。

故障必须予以修正，才能开始或恢复充电。

问题

充电手柄附近的白色LED指示灯不亮

可能原因	解决方法
该装置无电流供应	检查中央电气单元中的断路器和保险丝。

内部充电器故障	请联系您当地的沃尔沃经销商寻求帮助。
---------	--------------------

问题

车辆未充电。光环持续呈红色亮起。

可能原因	解决方法
充电手柄未正确连接至车辆。	检查充电手柄。从车辆拔下充电手柄；将手柄重新连接至车辆的充电插座，直到听到咔哒声。

车辆状态不允許充电	检查车辆的充电设置（如果车辆允许设置充电时间）。请参阅相应车辆的车主手册，了解具体说明。
-----------	--

充电器和车辆之间的通信故障	请联系您当地的沃尔沃经销商寻求帮助。
---------------	--------------------

故障排除

问题

光环呈红色迅速闪烁

可能原因

主电源故障

解决方法

- 通过中央电气柜中的断路器重置充电器。
- 如果问题仍然存在，请合格的电工检查墙壁插座的接地电路。

问题

光环呈红色迅速闪烁

可能原因

充电站的温度过高。充电器将在冷却后充新开始充电。

解决方法

- 检查充电站是否过热（摸起来烫手）。拔出充电手柄，使其冷却下来。如果问题仍然存在，请联系当地的沃尔沃经销商。
- 切断供至充电站的电流。
- 请电工检查该装置。执行必要的修理。

问题

充电器连接至车辆时光环呈红色常亮
充电器从车辆断开后，光环熄灭，LED指示灯亮起

可能原因

车辆故障

解决方法

请联系您当地的沃尔沃经销商寻求帮助。

故障排除

问题

充电器未连接至车辆时光环呈红色常亮

可能原因

内部充电器故障

解决方法

请联系您当地的沃尔沃经销商寻求帮助。

问题

光环交替呈红色和白色闪烁。

可能原因

充电器尝试解决内部故障

解决方法

充电器在一分钟内恢复正常运行。如果问题仍然存在，请联系您当地的沃尔沃经销商寻求帮助。

主要规格

型号	EVSE-VX
供电电压：	220 V，交流电
充电电流：	220 V时，16 A，交流电 (GB/T)
要求，断路器	220 V时，20 A，交流电 (GB/T)
频率：	50 Hz
电缆，主电源	电缆截面积符合当地法规
怠速能耗：	< 2 W
充电能耗：	< 4 W
电缆长度：	约7 m (23 ft.)
重量：	5.8 kg (12.75 lb.)
工作温度：	-40°C 至 +55°C (-40°F 至 +131°F)
存储和运输温度：	-40°C 至 +80°C (-40°F 至 +176°F)
环境标志：	IP66 (防水)
车辆-充电器通信协议：	GB/T 18487
充电方向：	主电源至车辆

规格如有变更，恕不另行通知。

高电压警告

警告！

电表和中央电气柜中存在高电压。接触高电压可能会导致死亡或严重伤害。

小心！

如果充电电缆、充电手柄或充电站损坏，不得使用充电站。使用前检查所有部件。如果发生损坏，请停止使用充电站，并联系您当地的沃尔沃经销商。

小心！

务必将充电电缆放在不挡道的位置，以免发生绊倒危险，或者存在碾压、踩踏、损坏或以其他方式受到压力的风险。始终在充电电缆未连接至车辆时将其存放在吊架上，以免导致人身伤害和充电站损坏。

小心！

仅利用充电站对配备SAE J1772类型1兼容插座的电动车充电。关于更多信息，请参见车主手册。

附录

注意！

清洁之前，请断开充电站的电流。
要清洁充电站，请用水或适用于车漆的温和清洁溶液蘸湿的布擦拭。
不得使用化学品或溶剂。
不得将充电器浸没在液体中。

65号提案警告（加州）**小心！**

本产品含有加利福尼亚州已知的可能导致癌症、出生缺陷或其他生殖损害（根据）的化学物质。

FCC信息

本产品符合FCC法规第15部分。使用应符合以下两种情形：

- 该产品不会造成有害干扰。
- 该产品必须承受所有受到的干扰，包括任何可能会导致操作异常的干扰。

本产品专为防止无线电干扰而设计。然而，存在强无线电信号或附近设备（数字电话、无线电通信设备等）影响运行的情况。

如果您怀疑充电器受到传入的无线电信号影响，请在联系客服支持进行维修之前执行以下步骤：

- 在充电期间将附近的电气装置或电气设备移开。
- 在充电期间关闭附近的电气装置或电气设备。

注意！

由授权电工以外的人员对充电站进行改动或改装不符合FCC规定。

符号说明



警告！

- 警告文本指示人身伤害风险。

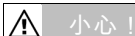

小心！

- 重要文本指示材料损坏风险。

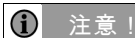

注意！

- 注意文本提供便于安装或使用的建议或技巧。

安全功能

充电站的设计以用户安全为最高优先级，包含以下防止触电的安全功能：

- 检查保护接地：

充电站持续检查接地连接。如果保护接地破损，则充电器的光环呈红色亮起，并且车辆的充电电流中断。

- 热事件传感器：

充电站检测到造成偏离的热事件，并在必要时关闭。

- 发生接地故障时的保护：

充电站配备用于防止触电的接地故障断路器。如果检测到接地故障，则切断对充电电缆的供电，光环则指示发生故障。

- 绝缘：

充电模块、适配器、接线和充电手柄完全绝缘（无外露导电部件），以免发生触电。

- 意外断开连接：

充电手柄专为最大限度降低意外断开连接风险而设计。当充电手柄未连接至车辆或在充电期间意外断开连接时，充电电缆中的信号导线和充电手柄可避免发生触电的危险。

在充电期间断开连接而不存在安全风险。

缩略语表

A	安培
AWG	美国线规
CE	Conformité Européene (欧洲符合性)
CQC	中国强制性认证
FCC	联邦通信委员会
GB/T	国标/T 中国国家ISO和IEC委员会推荐的标准。
Hz	赫兹
IEC	IEC 国际电工委员会
LED	发光二极管
UL	保险商实验室
V	伏特
W	瓦特





